

# Quick Reference Guide for Setup

## Step1

## Connection

**"Setup Will Not Work On A Mac®"**

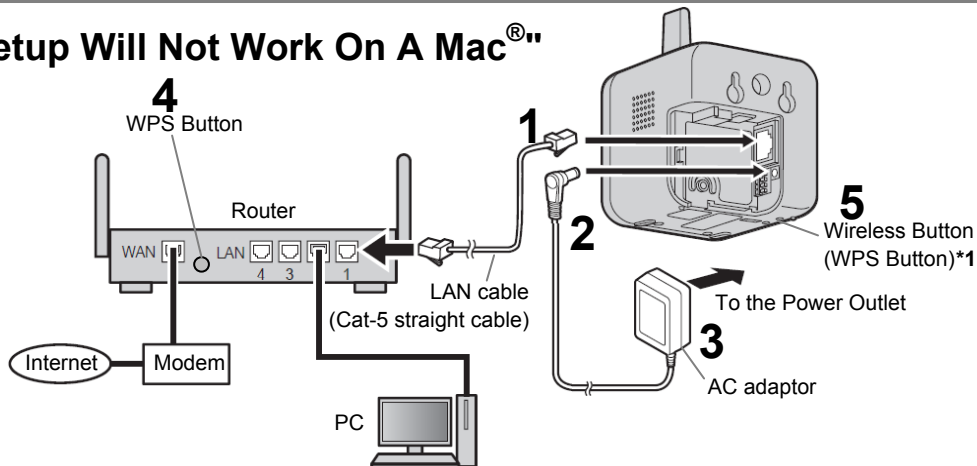

**BL-VT164W**

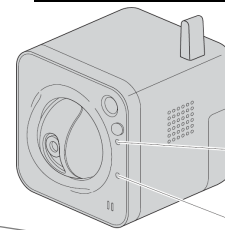

**BL-VP104W**

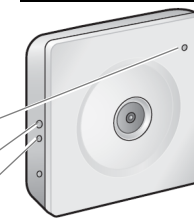

Power Indicator

6  
Wireless Indicator  
(WPS indicator)

\*1: WPS(Wi-Fi Protected Setup) is a computing standard that attempts to allow easy establishment of a secure wireless home network.

### In case of Wired Connection

1. Connect the LAN cable to the camera and the router.
2. Connect the AC adaptor cord to the DC IN jack.
3. Plug the AC adaptor into the power outlet, then go to Step2.

### In case of Wireless Connection

1. No LAN cable connection is required if router supports WPS. \*1
2. Connect the AC adaptor cord to the DC IN jack.
3. Plug the AC adaptor into the power outlet.

4. If your router has a WPS \*1 function, press the button on the back of the wireless router.

If NO WPS function on your router, please connect the LAN cable as the Wired Connection. (For detail information, refer to the operating instructions of the wireless router)

5. Press and hold down the WIRELESS button of the camera for a second or more until the indicator blinks orange.

It will restart, if this is successful. Please wait for about 2 minutes.

6. The WIRELESS indicator turns Green, then go to Step2.

If it's not turning Green indicator, you may need to check a Wireless router configuration or see the following Website for FAQ.

<http://panasonic.net/pss/security/support/info.html>

## Step2

## Setting of the Camera with CD from PC

1. Insert the CD-ROM into your PC.
  2. Click the [Run] of the IP Setting Software.
  3. Select the camera you want to configure, and click [Access Camera].
  4. The user authentication window will be displayed and then enter the default User name and Password, and log in.
  5. Setup is completed. For the operation, please refer to O/I in the CD-ROM.
- If the setup does not complete successfully, please see the following Website for FAQ.

<http://panasonic.net/pss/security/support/info.html>

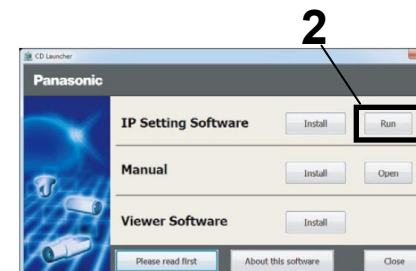

User name: admin  
Password : 12345

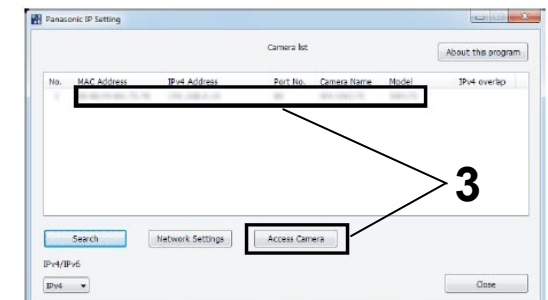

## Step3 if required

## Access from a mobile terminal

1. Click the [Setup] button.
2. Click the [Internet] button on the Setup Menu.
3. Select [On] for [UPnP(Auto port forwarding)].
4. Select [Viewnetcam.com] for [DDNS], then click [Set].
5. When [UPnP (Auto port forwarding) setup is complete.] is displayed, click [Go to Viewnetcam.com Registration page].

If the UPnP (Auto Port forwarding) setup fails, the router may not have UPnP enabled (It is disabled by default in most routers).

In this case, manual port forwarding will be required.

Refer to router's operating instructions for assistance.

For more information, refer to the operating instructions of your router. Or see the Website for FAQ.

<http://panasonic.net/pss/security/support/info.html>

6. When the Viewnetcam Page is displayed, click [New Registration] to register your information for the "Viewnetcam.com" service.
7. The registration is proceeded, Domain name shows up on the display. Please write down the Domain Name for accessing to viewnetcam later. The domain name will be enable in 30 minutes.
8. When the registration of the Viewnetcam service is complete, the global IP address of the camera is displayed in the [Setup Complete] window.

The global IP address shown is temporary because it will most likely change as soon as the router is restarted.

For a permanent link to the camera, please use the viewnetcam URL found in [Status] -[Viewnetcam] in the [Maintenance] section. Remember to add the tags after the URL if you are using a mobile device.

Example of URL to access the camera from different devices:

PC: <http://cam9014727.viewnetcam.com:50006>

Mobile: <http://cam9014727.viewnetcam.com:50006/mobile>

<http://cam9014727.viewnetcam.com:50006/cam>

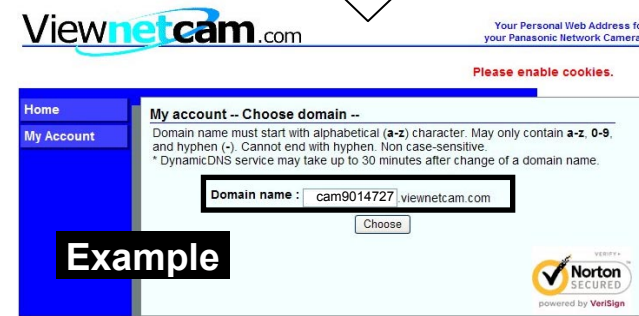
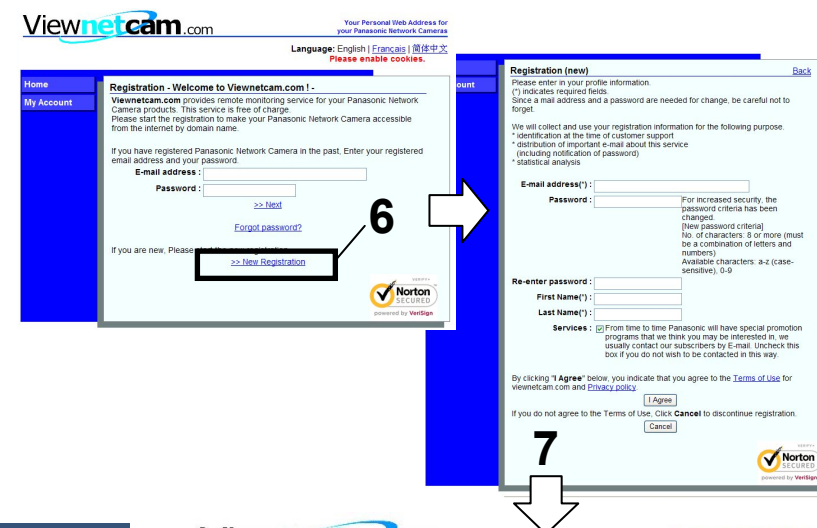
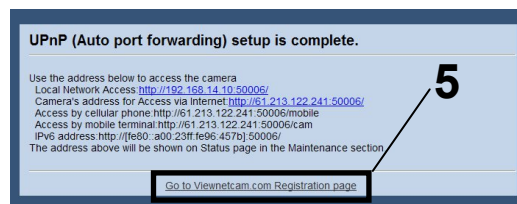
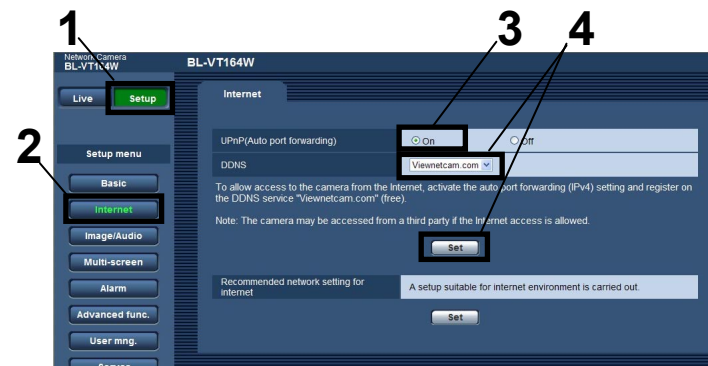

9. For detail information, please see the Installation Guide or Operating Instruction in the CD-ROM.