



Touch panel

## TY-TP60P30K

### ● Product Summary

A touch panel compatible with a 60-inch plasma display, this device achieves the high resolution of Approx. 2129 x 1201 while maintaining an extremely thin and compact design. With a built-in USB interface, the touch panel can be easily connected to peripheral devices of equipment such as personal computers.

### ● Product Specifications (Design and specifications are subject to change without notice.)

#### ■ SPEC

Detection system	Infrared retroreflective detection
Panel aperture(W x H)	1348.1 mm x 766.1 mm (53.1" x 30.2")
Detection range(W x H)	1330 mm x 750 mm (52.4" x 29.6")
Effective detection range	Above detection range +1.0 mm top, bottom, right, left
Resolution	533 (W) x 301 (H) (Hardware processing) 2129 (W) x 1201 (H) (Smoothing software processing)
Detection pitch	2.5 mm x 2.5 mm
Electronic pen(option)	Infrared system

#### ■ INTERFACE SPEC

Interface	USB 1.1 Compliance
Compliant signal	+DATA, -DATA, VCC, GND
I/F Connector	TYPE A (Cable connector)

#### ■ STRUCTURE

Panel shape	Flat panel
Dimensions (W x H x D) (Protruding parts and mounting bracket not included)	1442.2 mm x 860.2 mm x 12 mm (56.8" X 33.9" x 0.5")
Carton Dimensions (W x H x D)	1596 mm x 1041 mm x 95 mm (62.9" X 41.0" x 3.8")
Weight (Mounting bracket not included)	approx. 2.7 kg (5.9 lbs.)
Gross weight	approx. 11.4 kg (25.1 lbs.)
Escutcheon material/color	Aluminum (Filter is Polycarbonate)/Black

#### ■ ENVIRONMENT

Temperature (Temperature gradient under 25°C/Hr)*	Operation 0 to 40 °C
Humidity (No condensation)*	Operation 20 to 80 %

\* Touch panel only. When the panel is attached to a plasma display, please follow the use condition of the plasma display.

#### ■ ELECTRICAL

Power supply (voltage)	DC + 5 V ± 10 % (Supplied from USB bus power)
Electric current	DC + 5 V max 500 mA

#### ■ SUPPORTED OS

Windows XP-32bit (Single touch), Windows XP-64bit (Single touch), Windows Vista-32bit (Single touch), Windows Vista-64bit (Single touch), Windows7-32bit (Dual touch), Windows7-64bit (Dual touch)

#### ■ INCLUDED ACCESSORIES (T.B.D)

-Quick Start Guide -USB Cable (2m/2.2yd) -Mounting bracket and screws -Touch pen (2)  
-CD-ROM(Operating instructions, Calibration Management Software for Windows XP/VISTA)

### ● OPTIONAL ACCESSORIES

Electronic pen	TY-TPEN30
----------------	-----------

● Dimensions

Cautions: This drawing is not a scale

Units: mm (inches)

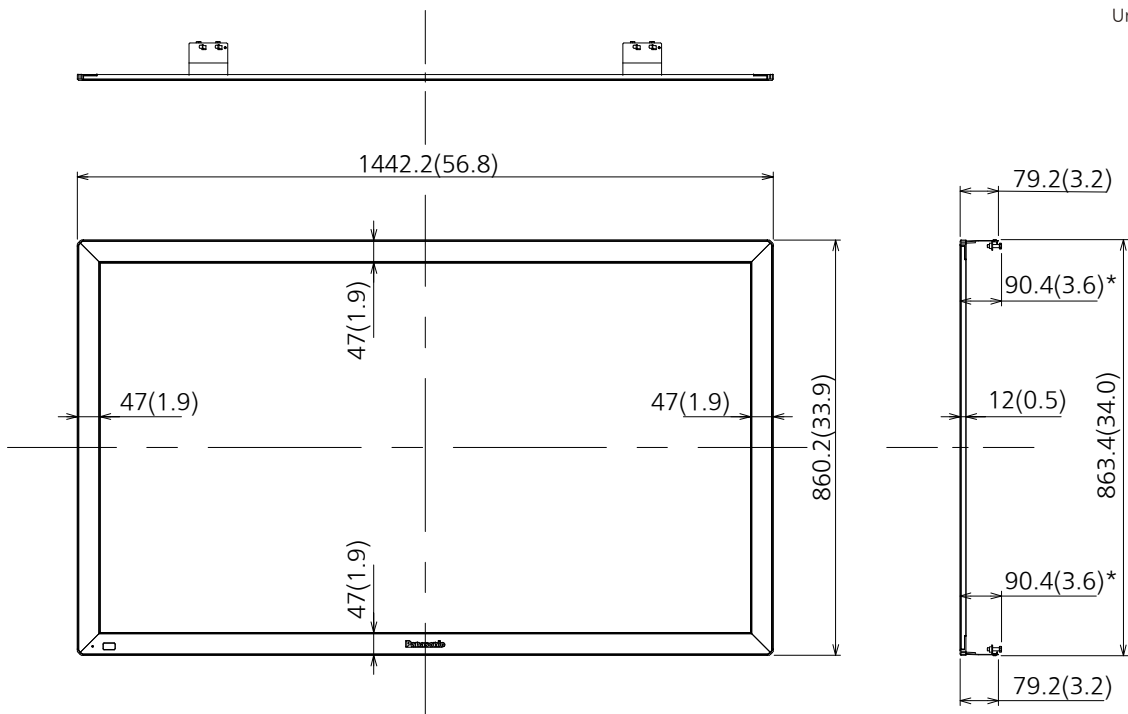

\*Dimensions may vary by the mounting set and the tightening state.

<With Display and Pedestal>

