



Panasonic Security Viewer for Smartphone

Specifications and settings

7th May 2018

Security Systems Business Division
Connected Solutions Company
Panasonic Corporation



Application Software Version history

1

Version	Contents
1.0	1) Supported DG-NV200
2.0	1) Supported DG-ND400/WJ-HD616/716, i-PRO SmartHD network camera / encoder 2) Supported Multi Live viewer
2.1	1) Supported WJ-NV300(Supported Mobile playback)
2.2	1) Supported the playback of H.264 recording data on SD card of i-PRO SmartHD network camera
3.0	1) Supported WJ-NX400 2) Supported i-PRO EXTERME network camera Android Version : Supported H.264/H.265 recording data on SD card iOS Version : Supported only H.264 recording data on SD card
3.1	1) Supported H.265 recording data on SD card of i-PRO EXTERME network camera for iOS Version
3.2	1) Supported WJ-NX200 2) Changed Company Name
3.3	1) Supported WJ-NX300 2) Supported 360-degree Dome 5/9 Megapixel i-PRO EXTREME Network Camera

System Configuration

2

Panasonic Security Viewer is a free application that you can live stream image and playback stored images of Panasonic network disc recorders and i-PRO SmartHD / i-PRO EXTREME series network camera on Android devices and iOS device by connecting to 3G / 4G line / Wi-Fi.

1) Live and Playback via Recorder Access

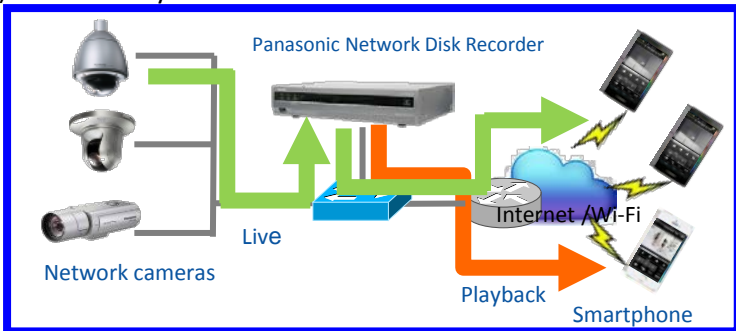

Note: Panasonic Security Viewer does not support third Party cameras.

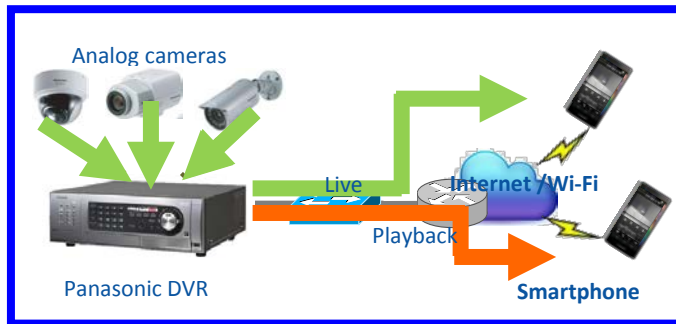

2) Live and Playback by camera Directly Access

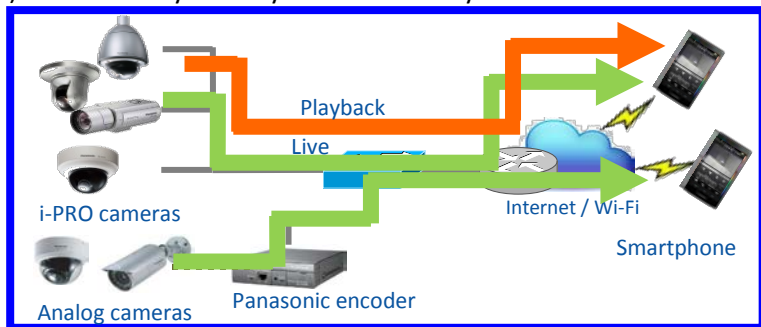

Connection Type

3

Connection Type of Panasonic Security Viewer are 2 connection methods.

- 1) Wi-Fi Connection (LAN)
- 2) Internet Connection (mobile communication (3G/4G/LTE))

1) Wi-Fi Connection (LAN)



2) Internet Connection (mobile communication (3G/4G/LTE))

Setup a port forwarding on Broadband router

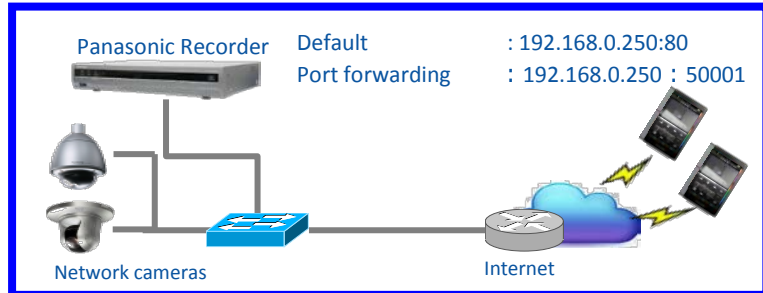

Apply DDNS, and set the URL and a port number.

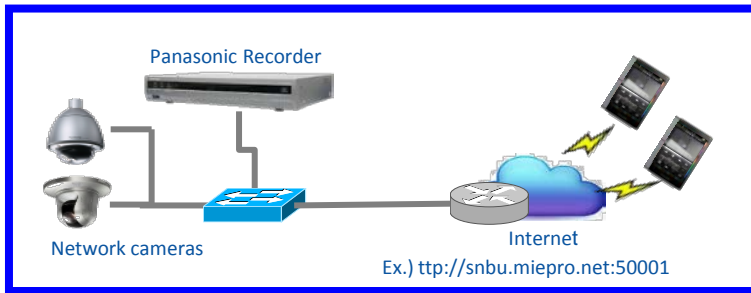

Functional overview

4

- 1) Live Functions : Pan/Tilt function, Preset function, Focus function, Resolution setting, Multi Live screen etc..
- 2) Playback Functions: Playback by recorder: Play / R.Play(Re-Play) / Stop/ Skip / R.Skip(Re-Skip) / FF(Fast Forward) / FR(Fast Rewind) / Prev(Frame advance) / Next(Frame return) / Search etc..
Playback of camera SD card: Play / R.Play(Re-Play) / Stop/ Skip / R.Skip(Re-Skip) / 10s Bwd(back Forward)/ 30s Fwd(Forward)/ Search etc..

Screen configuration (Support the vertical and horizontal)



- Centering with tap
- Digital zoom in pinch operation



Camera selection (Screen/Flick)

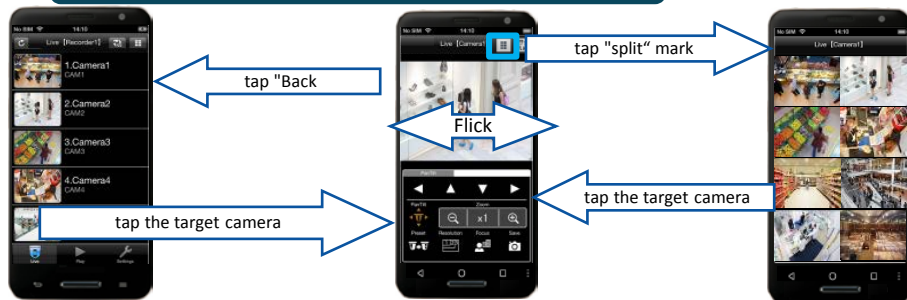

[Live] (MJPEG)

Pan/Tilt function



Preset function



Resolution setting



Focus function



[Playback] (recorder:H.264, SD card:H.254/H.265)

Playback function : Play/Pause/FF etc..



Supported Mobile Playback (Ver2.1 or later)

5

WJ-NV300/NV400/NX200/NX300 can re-encode Image size/bit rate to fit the customers environment, and stream it.

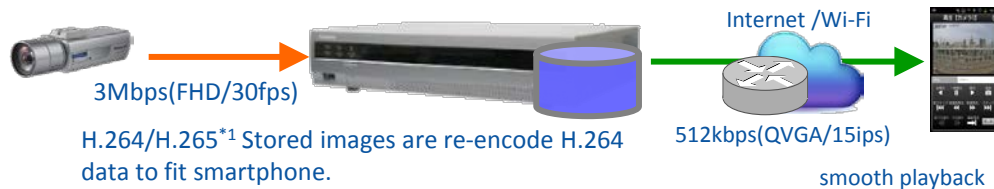

*1: WJ-NX400/NX200/NX300 can re-encode format from H.265 format to H.264 format. then you can playback stored H.265 format image stored on WJ-NX400/NX200/NX300.

Notes: This application cannot playback H.265 format image when playback mode is normal and low load.

When changing the default value in playback mode

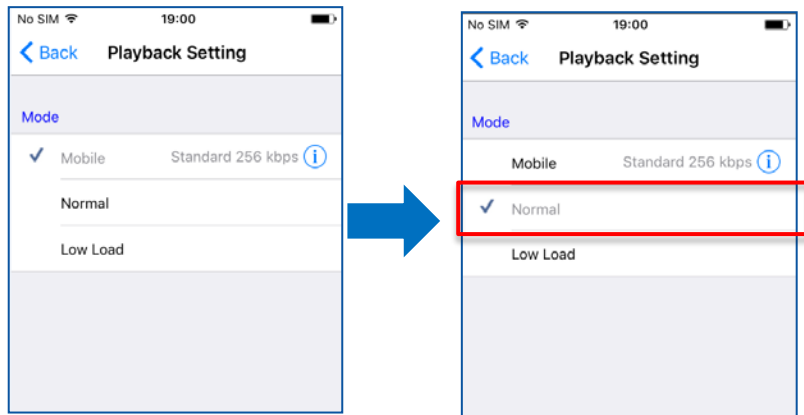

Playback mode is changed at the time of playback

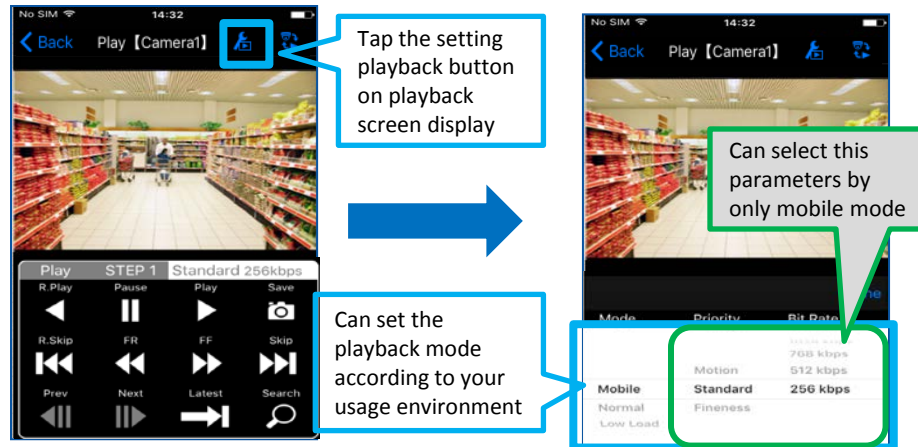

Supported the playback edge recording image (Ver2.2 or later)

6

Panasonic Security viewer can playback edge recording image stored on SD card of i-PRO SmartHD(Only H.264 format) / i-PRO EXTREME(H.264/H.265) Series Network camera, when connecting to camera directly access.

1) Playback edge recording image on SD card of i-PRO Series Network camera

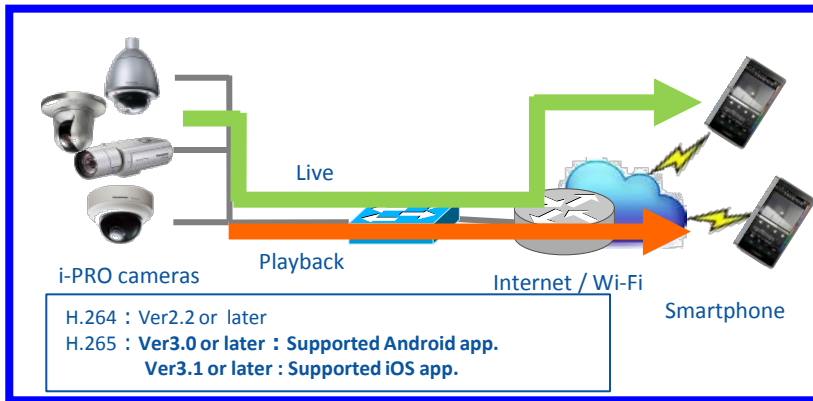

- Can playback edge recording image (H.264 format) stored on SD card of i-PRO SmartHD Series Network camera from **Ver2.2**.
- Can playback edge recording image (H.265 format) stored on SD card of i-PRO EXTREME Series Network camera from **Ver3.0**.

Note: 1) Android app can playback H.265 format image from **Ver3.0**.
2) iOS app can playback H.265 format image from **Ver3.1**.

Restrictions:

- Android app. can playback H.265 format image stored on SD card by Android OS **5.0 or later** devices.
- If Android OS version is under 5.0 such as **4.0, 4.1, 4.2, 4.3 and 4.4**, Android app. cannot playback H.265 format image stored on SD card of camera.

Playback operation of edge recording image

7

1) Playback the edge recording image

2. Tap the camera which you want to playback

3. Start playback

1. Tap the playback tab

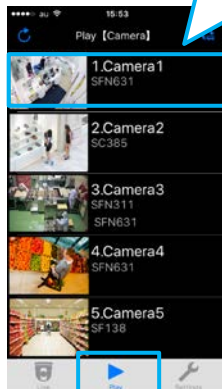

Search operation of edge recording image (Time & date / Event)

8

2) Playback the edge recording image from the specified time & date

3) Playback the edge recording image which selecting the event record

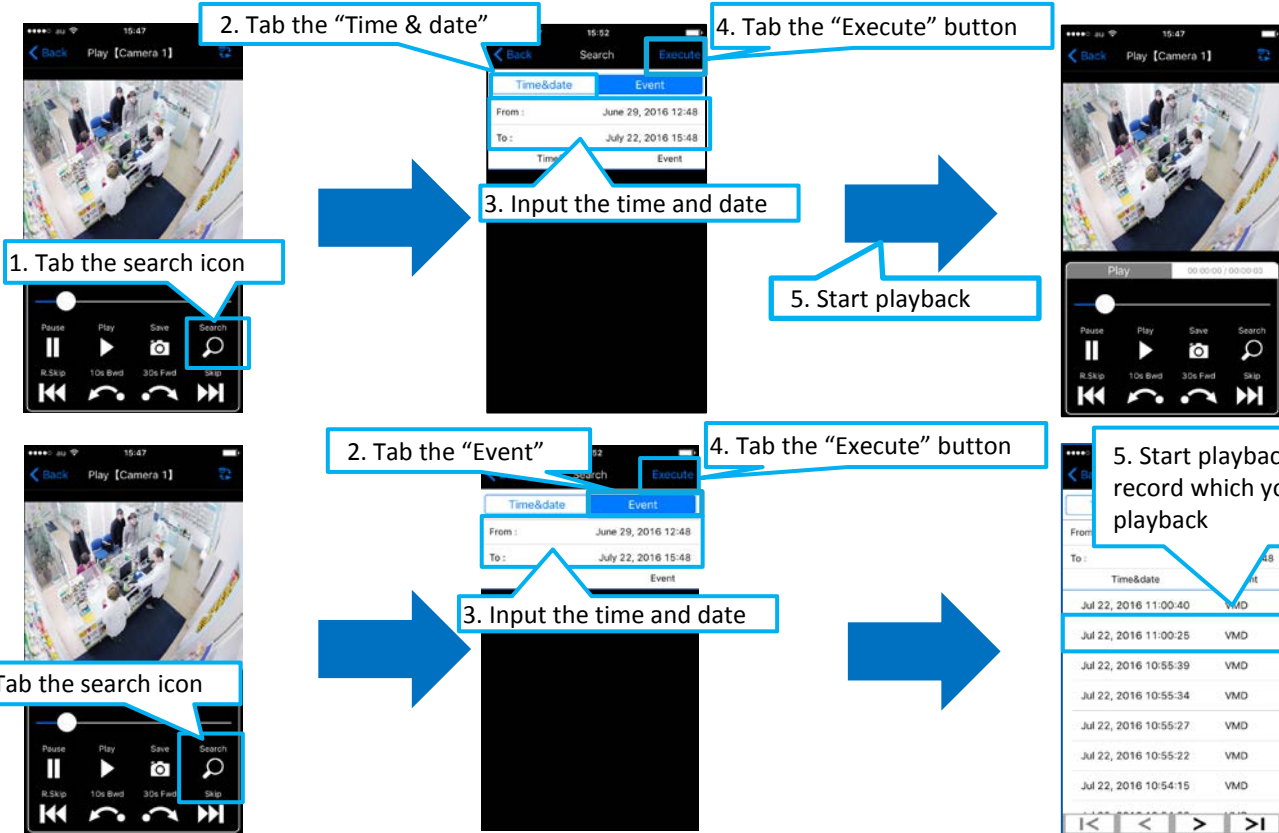

Specification (1/7)

9

Item			Details	
OS			iOS: 8.0 or later / Android : 4.0 – 6.0	
Wireless Network			4G/3G, Wi-Fi	
Number of registrations of Recorders , Cameras and Encoders			Camera and encoder : up to 50ch + Recorder : up to 50 units	
Device Registration	Name		Up to 16 characters	
	Device Type		Recorder / Camera / Encoder	
	Address		IP address / Domain Name	
	Port Num		0 - 65535	
	User Name		Up to 32 characters	
	Password		Up to 32 characters	
	Live setting	Frame rate	Depend on camera setting / 0.5 / 1 / 2 / 5 fps	
		Resolution	Depend on camera setting / 320 / 640 / 1280 *WJ-HD716/616 is fixed 320	
		Connection setting (Only Recorder)	Via Recorder (default) / Direct Camera Access * Direct Camera Access is not supported by WJ-ND400/WJ-HD716/616	
	Playback setting* ¹	Mode	Low load / Normal / Mobile *Mobile mode is supported by WJ-NV300/NX400/NX200	

*1: When Device Type is Recorder, this item is displayed.

Specification (2/7)

10

Item		Details
Live GUI function	Multiscreen mode	6 split / 8 split *6/8split which uses WJ-HD616/716 are not supported.
	Landscape	✓
	Screen switching	<ul style="list-style-type: none"> - display the live image of the previous or next camera by flick operation. - change to single screen from multi screen by tap on the target camera. - change to multi screen from single screen by screen switching button. - change to Playback screen from Live screen by Live-Playback switching button.
	Camera control	Pan/Tilt, Zoom, Focus (Near, Far, Auto), Preset position call (HOME, 1 - 3)
	Digital Zoom	✓ (pinch in, pinch out)
	Saving image	iOS: to camera roll / Android: to gallery or picture album
	Live-Playback switching	✓ (Only Live screen)
	Device switching	✓ (Only displayed Live camera list)

Specification (3/7)

11

Item		Details
Playback GUI function	Multiscreen mode	Single screen only
	Landscape	✓
	Screen switching	- display the live image of the previous or next camera by flick operation. - change to Live screen from Playback screen by Live-Playback switching button.
	Playback control	From Recorder
		From SD card of camera
	Search	PLAY, Pause, Rev PLAY, Skip/Rev Skip, FF/REW, Go to last (depend on recorder setting)
	Digital Zoom	PLAY, Pause, Skip/Rev Skip, FF/REW, 10 Bwd, 30s Fwd, Slider bar
	Saving image	Time & date / Event (Only SD card Playback)
	Playback mode switching	✓ (pinch in, pinch out)
	Live-Playback switching	iOS: to camera roll / Android: to gallery or picture album
Device switching		✓ (Only Mobile Playback)
Live-Playback switching		✓ (Only Playback screen)
Device switching		✓ (only displayed Live camera list)

Specification (4/7)

12

Item		Details
Language		Japanese / English / Chinese
Audio		-
Image Format	Live data	MJPEG : i-PRO series network disk recorder / camera / encoder
		H.264 : WJ-HD716/616
	Playback data	H.264 : Stored data of i-PRO series recorder Stored data of i-PRO series network camera that is supported SD card (Ver2.2 or later)
		H.265 : i-PRO EXTREME series network recorder / camera 1) H.265 stored data of SD card 1-1) iOS : Available (Ver3.1 or later) 1-2) Android : Mobile phone of Android OS 5.0 or more is available (Ver3.0 or later) Mobile phone of Android OS less than 5.0 (4.0,4.1,4.2,4.3,4.4)is not available. 2) H.265 stored data of WJ-NX400/NX200/NX300 Mobile : Available (NX400/NX200/NX300 is re-encode to H.264 format form H.265 format) Normal / low load : Not available (H.265 format is not supported)

Specification (5/7)

13

Item		Details
Supported network cameras*4	(A) Firmware Ver. 1.64 or later	WV-SW559, WV-SW558, WV-SF549, WV-SF548, WV-SF539, WV-SF538, WV-SP509, WV-SP508, WV-SW598(A), WV-SW397(A/B), WV-SC588(A), WV-SC387(A), WV-SW458(M,MA)*1, WV-SF448E*1, WV-SF438*1, WV-SW158, WV-SF138
	(B) Firmware Ver. 2.00 or later*2	WV-SW395(A), WV-SC385, WV-SC384, WV-SW155(M/MA), WV-SW152(M), WV-SF135, WV-SF132, WV-SW115, WV-SP105, WV-SP102, WV-SW175, WV-SW172, WV-SW174W, WV-ST165, WV-ST162, WV-SW396(A), WV-SC386, WV-SW355, WV-SW352, WV-SF346, WV-SF342, WV-SF336, WV-SF335, WV-SF332, WV-SW316(L), WV-SW314, WV-SP306, WV-SP305, WV-SP302, WV-NP502, WV-NW502S
	(C) Firmware Ver. 1.84 or later	WV-SFV631(LT/L), WV-SFV611L, WV-SFR631L, WV-SFR611L, WV-SFN631L, WV-SFN611L, WV-SPW631(LT/ L), WV-SPW611(L), WV-SPN631, WV-SPN611, WV-SFV531, WV-SFR531, WV-SFN531, WV-SPW531AL, WV-SPW532L, WV-SPN531(A), WV-SFV311(A), WV-SFV310(A), WV-SFR311(A), WV-SFR310(A), WV-SFN311(A/L), WV-SFN310(A), WV-SPN311(A), WV-SPN310(A), WV-SPW311AL, WV-SPW312L, WV-SFV130(M), WV-SFV110(M), WV-SFN130, WV-SFN110, WV-SBV131M, WV-SBV111M, WV-SUD638
	(D) Firmware Ver. 1.07 or later	WV-SFV481*1, WV-SFN480*1, WV-SPV781L, WV-SPV781U
	(E) Firmware Ver. 1.20 or later	WV-S2531(LTN/LN), WV-S2511LN, WV-S2231L, WV-S2211L, WV-S2131(L), WV-S2130, WV-S2111L, WV-S2110, WV-S1531(LTN/ LN/ LNS), WV-S1511LN, WV-S1132, WV-S1131, WV-S1112, WV-S1111
	(F) Firmware Ver. 1.05 or later	WV-X6531(N/NS), WV-X6511N, WV-S6530N, WV-S6131, WV-S6111, WV-S6130
	(G) Firmware Ver. 1.00 or later	WV-S4550(L/LM), WV-S4150, WV-X4571L(L/LM), WV-X4171, WV-X4170
	(V) Firmware Ver. 2.42 or later*3	WV-V1170, WV-V1130(LK/ L1), WV-V2530(LK/ L1), WV-V6430L

*1: When "Image capture mode" of JPEG is only Single PTZ, you can control PTZ function.

*2: The security viewer has a functional constraint for these models.

*3: WV-V Series cameras : 1) SD playback function is not supported.

2) Resolution and Framerate of Live ((MJPEG) cannot change.

*4: **Panasonic Security Viewer does not support third Party cameras.**

Specification (6/7)

14

Item		Details
Supported network cameras that Supported SD card Playback Feature	(A) Firmware Ver. 1.64 or later	WV-SW598(A), WV-SW397(A/B) , WV-SC588(A), WV-SC387(A), WV-SW458(M/MA), WV-SF448(E), WV-SF438, WV-SW158, WV-SF138, WV-SW559, WV-SW558, WV-SF549, WV-SF548, WV-SF539, WV-SF538, WV-SP509, WV-SP508
	(B) Firmware Ver. 2.00 or later* ¹	WV-SW395(A), WV-SC385, WV-SC384, WV-SW155(M/MA), WV-SW152(M), WV-SF135, WV-SW115, WV-SW175, WV-SW172, WV-ST165, WV-ST162, BL-VT164(W), BL-VP104W, BL-VP101, WV-SW396(A), WV-SC386, WV-SW355, WV-SW352, WV-SF346 , WV-SF342, WV-SF336, WV-SF335, WV-SF332, WV-SW316(L), WV-SW314, WV-SP306, WV-SP305, WV-SP302, WV-NP502, WV-NW502S
	(C) Firmware Ver. 1.84 or later	WV-SFV631(LT/L), WV-SFV611L, WV-SFR631L, WV-SFR611L, WV-SFN631L, WV-SFN611L, WV-SPW631(LT/L), WV-SPW611(L), WV-SPN631, WV-SPN611, WV-SFV531, WV-SFR531, WV-SFN531, WV-SPW531AL, WV-SPW532L, WV-SPN531(A), WV-SFV311(A), WV-SFV310(A), WV-SFR311(A), WV-SFR310(A), WV-SFN311(A/L), WV-SFN310(A), WV-SPN311(A), WV-SPN310(A), WV-SPW311AL, WV-SPW312L, WV-SFV130(M), WV-SFV110(M), WV-SFN130, WV-SFN110, WV-SBV131M, WV-SBV111M
	(D) Firmware Ver. 1.07 or later	WV-SFV481, WV-SFN480, WV-SFV781L, WV-SPV781L
	(E) Firmware Ver. 1.20 or later	WV-S2531(LTN/LN), WV-S2511LN, WV-S2231L, WV-S2211L, WV-S2231L, WV-S2131(L), WV-S2111L, WV-S1531(LTN/LN/LNS), WV-S1511LN, WV-S1132, WV-S1131, WV-S1112, WV-S1111
	(F) Firmware Ver. 1.05 or later	WV-X6531(N/NS), WV-X6511N, WV-S6530N, WV-S6131, WV-S6111, WV-S6130
	(G) Firmware Ver. 1.00 or later	WV-S4550(L/LM), WV-S4150, WV-X4571L(L/LM), WV-X4171, WV-X4170

*1: Regarding (B) cameras, the application do not support following Play Features.

1) Reverse Skip 2) Event Search

Item	Details
Supported recorders	WJ-NV200 : Version 1.50 or later WJ-NV300 : Version 1.03 or later WJ-ND400 : Version 3.40 or later, WJ-HD616/716 : Version 2.60 or later WJ-NX400 : Version 1.20 or later WJ-NX200 : Version 1.20 or later WJ-NX300 : Version 1.00 or later
Supported encoders	WJ-GXE100 : Ver. 1.81 or later WJ-GXE500 : Ver.1.50 or later

Validated mobile phone / pad

Android : Galaxy S2, Galaxy S3, Galaxy S4, Xperia Z1, Xperia Z5, Nexus5, Nexus5X, Nexus7, Nexus9, ASUS ZenPad

iOS : iPhone5, iPhone5S, iPhone6, iPhone6 Plus, iPhone6s, iPhone7, iPhone X, iPad Retina, iPad Air, iPad mini, iPad Pro

⚠️ **Panasonic Security Viewer does not support third Party products.**

Regarding Number of Accessible users (Live/Playback)

16

Live feature and Playback feature have the limitation number of connecting terminals. Please refer the following the table.

Function	Type	Device	Max. user No. *1	Accesses Priority
Live	Camera Directly	i-PRO SmartHD/EXTREME series camera/WJ-GXE500/GXE100	14/CH	previously *2
		WJ-NV200/NV300/NX400/NX200/NX300	13/CH	
	Via recorder	WJ-NV200/NV300/ND400/HD616/HD716	1/CH	later*3
		WJ-NX400/NX200/NX300	13/CH	previously *2
Playback	Normal/ Low rate	WJ-NV200	4	later *3
		WJ-NV300	8	
		WJ-ND400	16	
		WJ-HD616/HD716	8	
		WJ-NX400/NX200/NX300	16	
	Mobile	WJ-NV300	1	previously *2
		WJ-NX400/NX200 /NX300	2	
	Edge recording	i-PRO SmartHD/ EXTREME series camera : up to 1 user	1	previously *2

*1: Contain access users of PC application (etc. ASM200/ASM300)/PC browser (Camera or Recorder) .

*2: In case the customers access the same camera, the customer who accessed previously will have the right of the camera control.

*3: In case the customers access the same camera, the customer who accessed later will have the right of the camera control.

Accessible user (Live) (1/9)

17

The number of accessible users of each camera(encoder) is up to 14 by Camera Directly Access .

Camera Directly Access

The number of accessible users of each camera = up to 14

* Depending on Access number*1 of Smartphone software / of PC application software (etc. ASM200/ASM300) / of PC browser on camera/encoder, the actual access number may be less than Max. access number.

When exceeding the number of accessible users, priority is given to the user who **accessed previously**. (Users who accessed later can not playback)

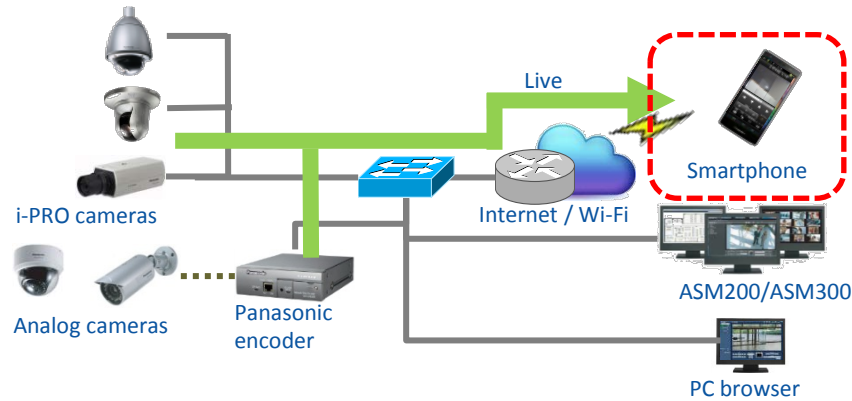

Camera Directly Access

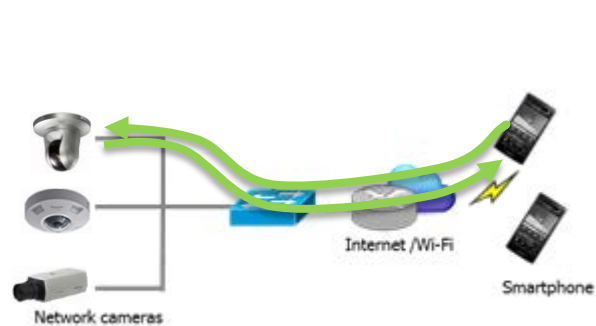

different camera

same cameras

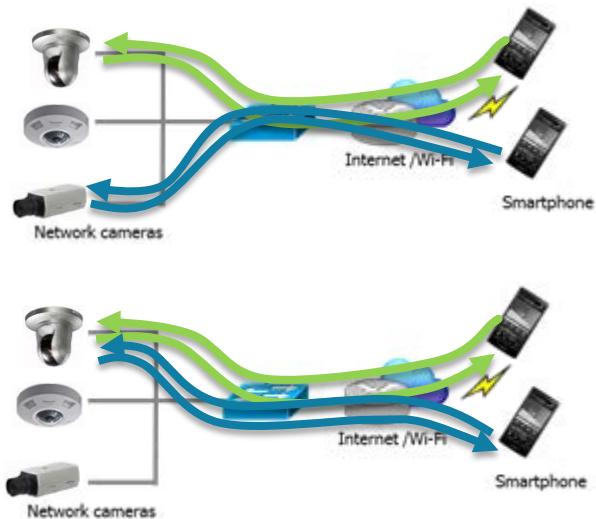

When you access a different camera, you can display live images.

When you access to a same camera, can display live image (Max. 14).

Accessible user (Live) (3/9)

19

The number of accessible users of each camera is only one on WJ-NV200/NV300/ND400/HD616/HD716 by using “Via recorder” of connecting method.

WJ-NV200/NV300/ND400/HD616/HD716 (Via recorder)

The number of accessible users of each camera = 1

When exceeding the number of accessible users, priority is given to the user who **accessed later**. (Users who accessed later can playback)

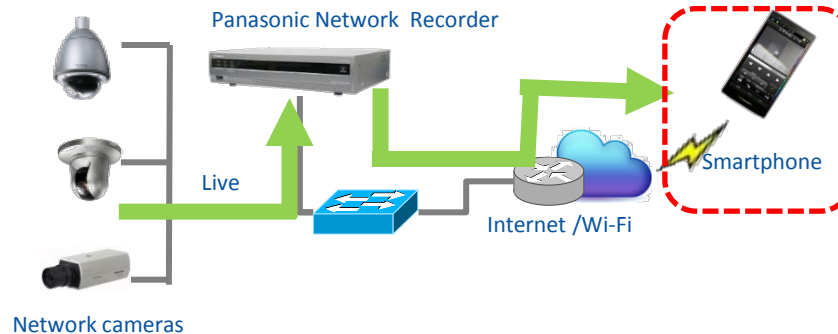

WJ-NV200/NV300/ND400/HD616/HD716 (Via recorder)

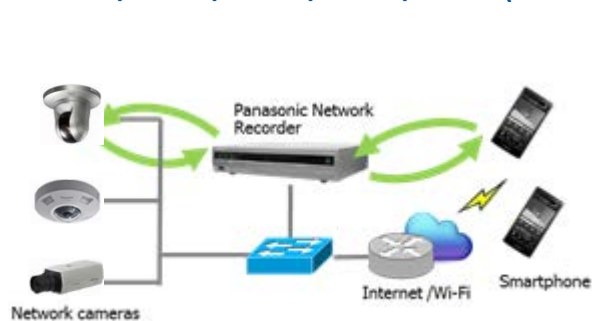

When you use other recorder and live connecting method is "via recorder. The number of user is **[1]** .

different camera

same cameras

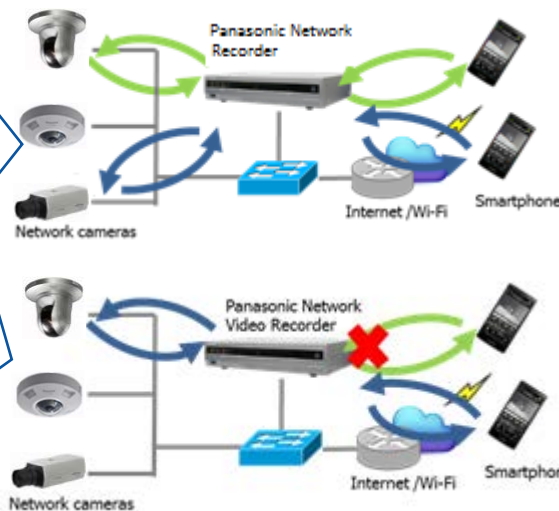

When you access to a different camera, can display live images.

When you access a same camera, cannot display live image.

Only one user can display live stream of one camera.

When the second user access the same camera, the first user's screen turns into a black screen since an access priority is given to the user who **accessed later**.

Accessible user (Live) (5/9)

21

The number of accessible users of each camera are up to 13 on WJ-NV200/NV300 by using “Camera directly” of connecting method.

WJ-NV200/NV300 (Camera directly)

The number of accessible users of each camera = **up to 13**

* Depending on Access number*¹ of Smartphone software / of PC application software (etc. ASM200/ASM300) / of PC browser on camera/encoder, the actual access number may be less than Max. access number.

When exceeding the number of accessible users, priority is given to the user who **accessed previously**. (Users who accessed later can not playback)

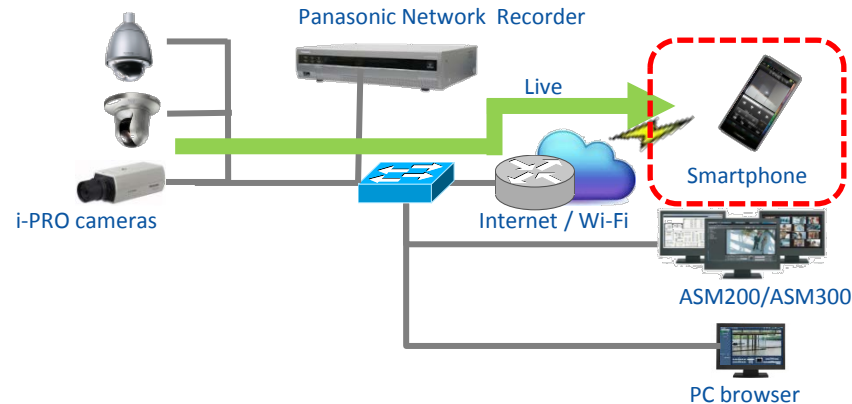

WJ-NV200/NV300 (Camera directly)

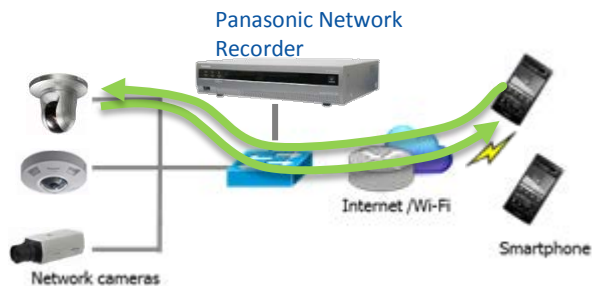

different
camera

same
cameras

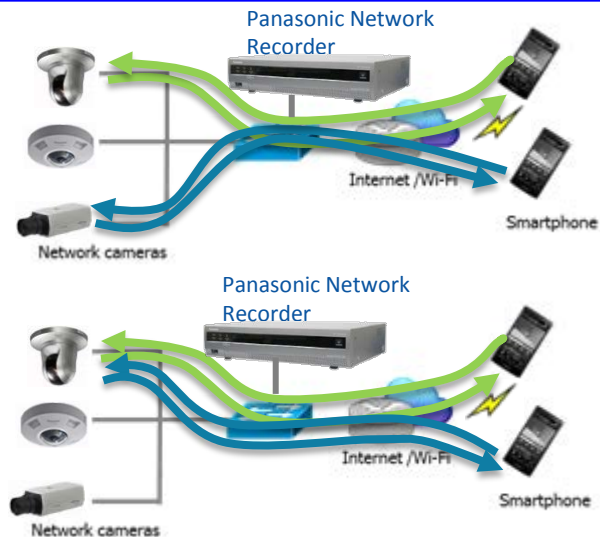

When you access to a different
camera, can display live images.

When you access to a same camera,
can display live image (Max. 13).

Accessible user (Live) (7/9)

23

The number of accessible users of each camera are up to 13 on WJ-NX400/NX200/NX300 by using “Via recorder” and “Camera directly” of connecting method.

WJ-NX400/NX200/NX300 (Via recorder / Camera directly)

The number of accessible users of each camera = **up to 13**

* Depending on Access number*1 of Smartphone software / of PC application software (etc. ASM200/ASM300) / of PC browser on camera/encoder, the actual access number may be less than Max. access number.

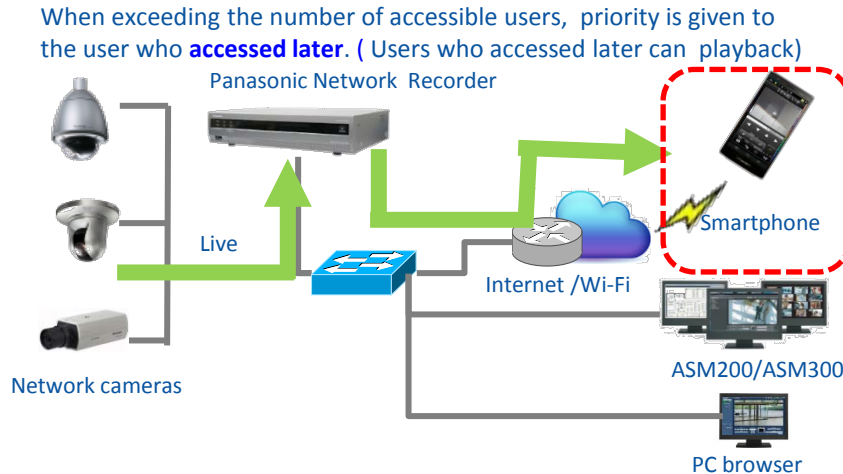

When exceeding the number of accessible users, priority is given to the user who **accessed previously**. (Users who accessed later can not playback)

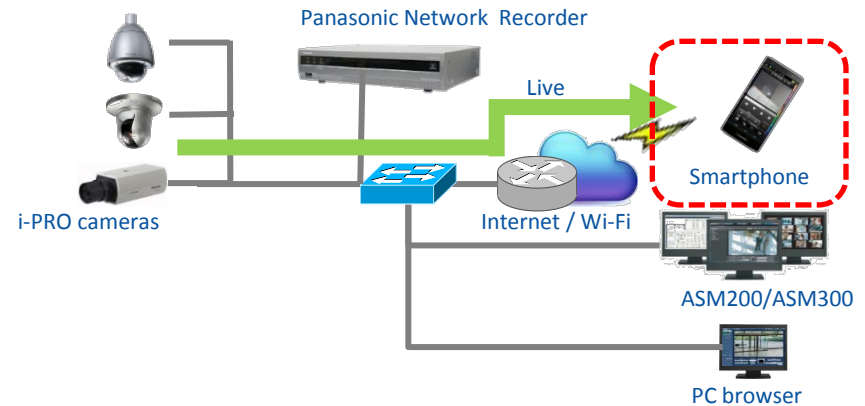

WJ-NX400/NX200/NX300 (Via recorder)

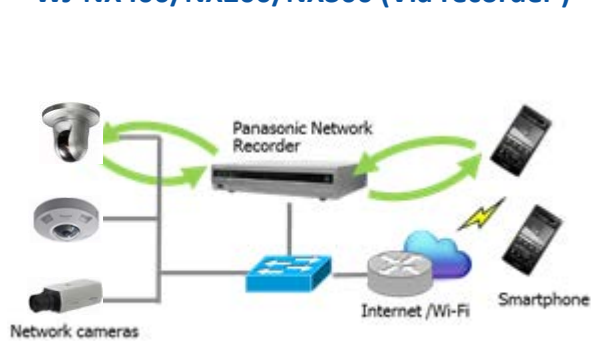

*When you use WJ-NX400/NX200/NX300 and live connecting method is “via recorder”. The number of users is [13].

different camera

same camera

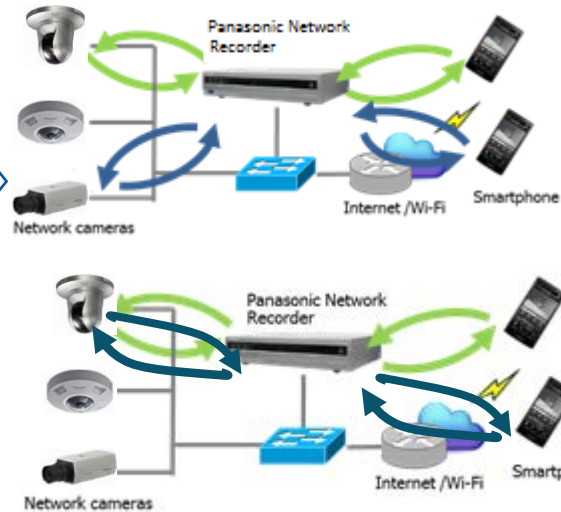

When you access a different camera, you can display live images.

When you access to a same camera, can display live image (Max. 13).

PC browser

WJ-NX400/NX200/NX300 (Camera Directly)

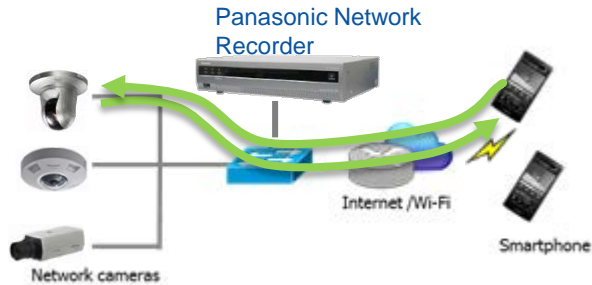

*When you use WJ-NX400/NX200/NX300 and live connecting method is "Camera directly". The number of users is **[13]**.

different
camera

same
cameras

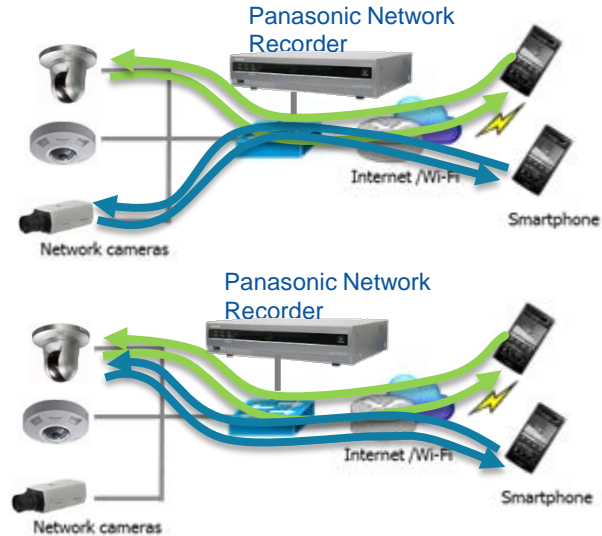

When you access a different camera, you can display live images.

When you access to a same camera, can display live image (Max. 13).

PC browser

Accessible user (Playback) (1/2)

26

Playback mode : Normal / Low rate

Access number of each recorder (Maximum Number) :

WJ-NV200(4), WJ-NV300(8), WJ-ND400(16), WJ-HD616/HD716(8),
WJ-NX400/NX200/NX300(16)

* Depending on Access number^{*1} of Smartphone software / of PC application software (etc. ASM200/ASM300) / of PC browser on camera/encoder, the actual access number may be less than Max. access number.

When exceeding the above Access number^{*1}, priority is given to user who **accessed later**. (Users who accessed later can playback)

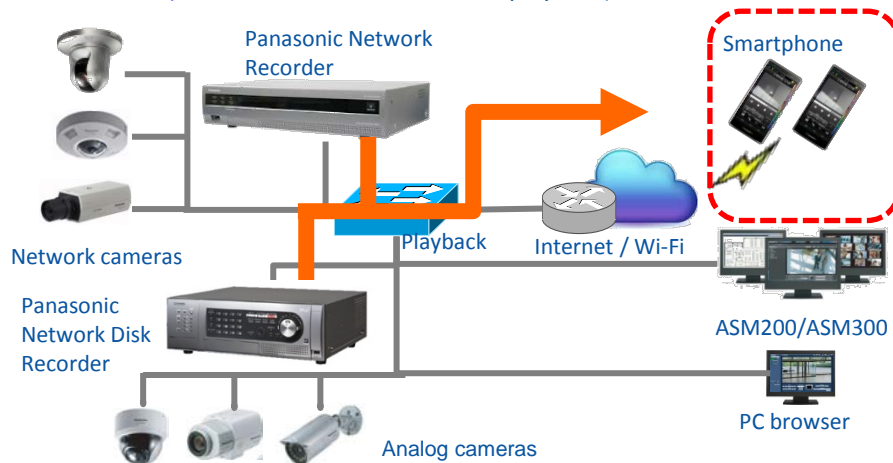

*1 : Access number means the sum of live number and playback number except mobile playback.

Playback mode : Mobile

WJ-NV300 : Mobile playback number = 1

WJ-NX400/NX200/NX300: Mobile Playback number = 2

Mobile Playback can use by WJ-NV300/NX400/NX200.

When exceeding the above Playback number, priority is given to the user who **accessed previously**. (Users who accessed later can not playback)

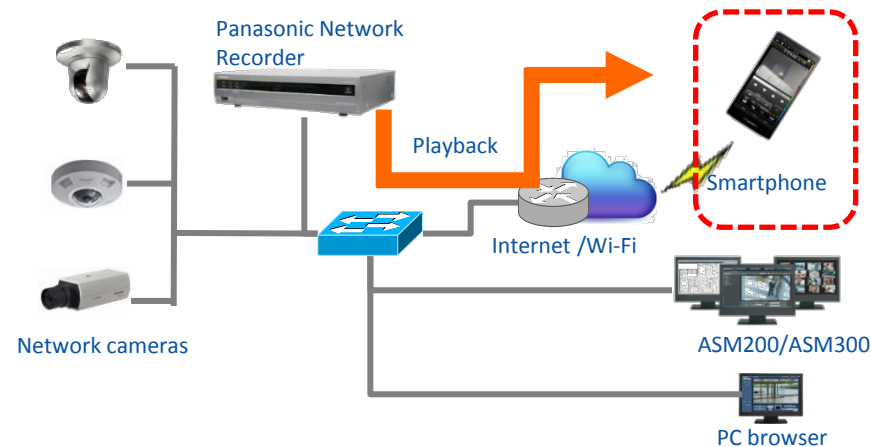

Accessible user(SD card Playback) (2/2)

27

SD card Playback of one camera = 1

When exceeding the number of accessible users, priority is given to the user who **accessed previously**.
(Users who accessed later can not playback)

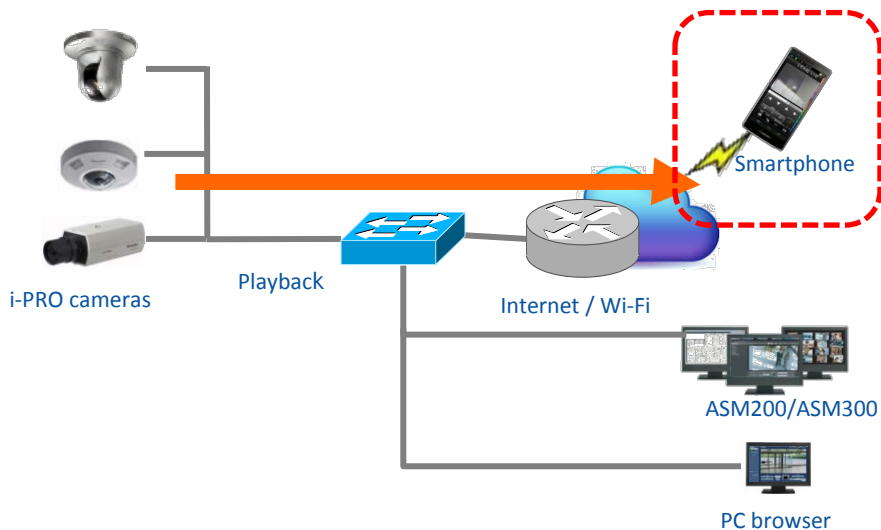

Panasonic Security Viewer Setup Procedure

0

Setup to Registration

1

Registration of Recorder

2

Registration of Camera and Encoder

0**Setup to Registration****1****Registration of Recorder****2****Registration of Camera and Encoder**

Connection environment of Recorder and Camera (1/3)

31

Panasonic Security viewer can access recorder by using following connection.

- 1) LAN Connection (Wi-Fi)
- 2) Internet Connection (communication (3G/4G/LTE))

1) LAN Connection (Wi-Fi)

Step 1 Surveillance system (Recorder / Camera / Wi-Fi Router) connect to local network (LAN).

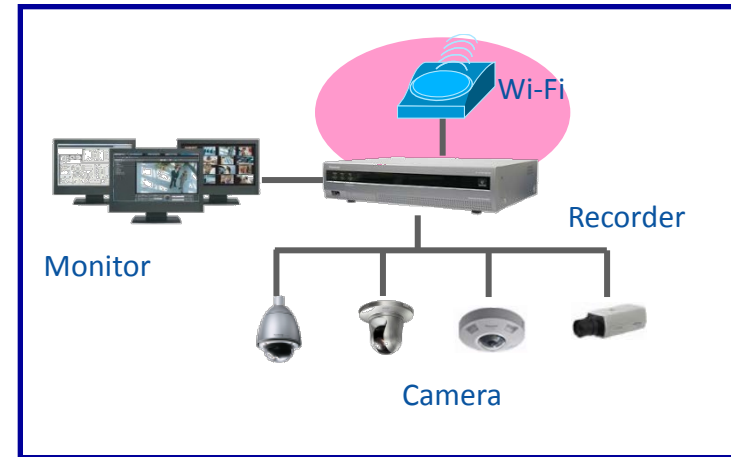

Connection environment of Recorder and Camera (2/3)

32

2-1) Accessing the recorder via the Internet (mobile communication (3G / 4G / LTE))

Step 1 Connect the surveillance system to the internet, and setup a network router etc.

Step 2 Set Dynamic DNS (DDNS) on the Panasonic recorder.

When you use the "viewnetcam.com" service, you select "Viewnetcam.com".

When you use other services, you select "Dynamic DNS Update".

You can skip this step, when a "fixed" global IP address is not assigned on the router. (not recommended)

DDNS Setup	
DDNS	<input type="text" value="Viewnetcam.com"/>
Personal(Product) URL	<input type="text"/>
Your account link	<input type="text"/>
Access interval	<input type="text" value="1 h"/>

DDNS setup screen of WJ-NX400

Step 3 Set the port forwarding to the recorder on the router.

*Please refer the manual of your router about setting of the port forwarding.

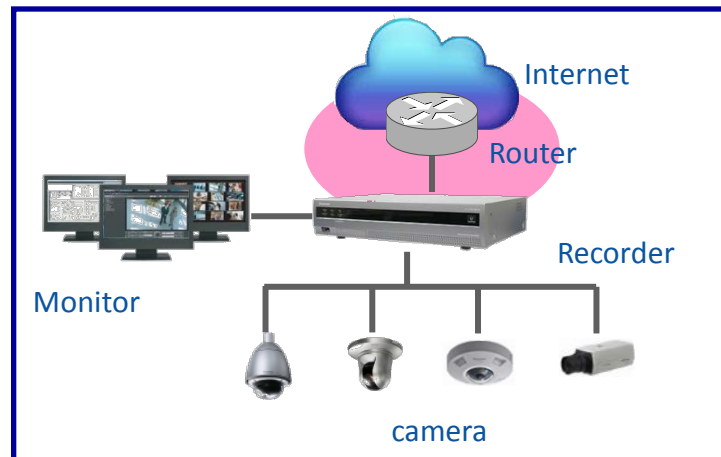

Connection environment of Recorder and Camera (3/3)

33

2-2) Accessing the camera / encoder via the Internet (mobile communication (3G / 4G / LTE))

Step 1 Connect the surveillance system to the internet, and setup a network router etc.

Step 2 Set Dynamic DNS (DDNS) on each Panasonic Network camera or encoder.

When you use the "viewnetcam.com" service, you select "Viewnetcam.com".

When you use other services, you select "Dynamic DNS Update" or "Dynamic DNS Update(DHCP)".

You can skip this step, when a "fixed" global IP address is not assigned on the router. (Not recommended)

The screenshot shows the 'Advanced' tab of the network configuration page. Under the 'DDNS' section, the 'Area' is set to 'Global' and the 'Service' is set to 'Viewnetcam.com'. Other fields include 'Personal(Camera) URL', 'Your Account Link', 'Access interval' (set to 1h), and 'Global IP Address Notification Method' (with 'Normal' selected).

DDNS setup screen of Network camera

Step 3 Set the port forwarding to the camera on the router.

When your router is non-supported UPnP, please confirm the camera IP address and port number , set these on the port forwarding on the router. *Please refer the manual of your router about setting of the port forwarding.

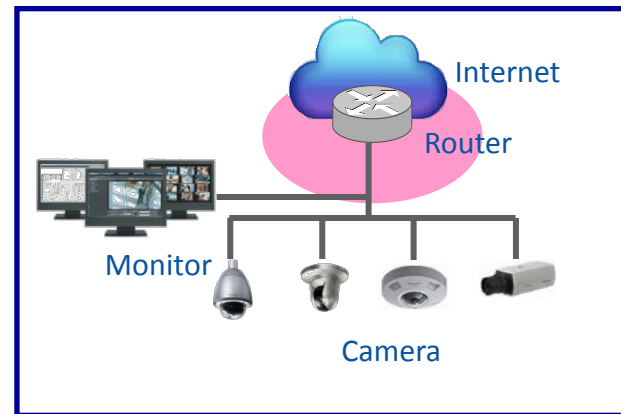

Register an access user on recorder (1/2)

34

Step 1 Register access users through Panasonic security viewer on the recorder .

User registration screen of WJ-NX400

PC browser

Register an access user on camera and Encoder (2/2)

35

Step 1 Register access users through Panasonic Security Viewer on the camera / encoder.

The screenshot shows the 'User auth.' tab selected in the Panasonic Security Viewer interface. The top navigation bar includes 'User auth.', 'Host auth.', 'IEEE 802.1X', and 'Data encryption'. The main configuration area has three rows of settings: 'User auth.' with radio buttons for 'On' (selected) and 'Off'; 'Guest User' with radio buttons for 'Use' (selected) and 'Not use'; and 'Authentication' with a dropdown menu set to 'Digest or Basic'. Below these is a 'Set' button. The bottom section is for 'User name registration', featuring a dropdown menu with '--New registration--', 'Change', and 'Delete' buttons. It includes four input fields: 'User name (1 to 32 characters)', 'Password (8 to 32 characters)', 'Retype password', and 'Access level' (a dropdown menu set to '3. Live only'). A final 'Set' button is at the bottom.

User auth.		Host auth.		IEEE 802.1X		Data encryption	
User auth.	<input checked="" type="radio"/> On			<input type="radio"/> Off			
Guest User	<input type="radio"/> Use			<input checked="" type="radio"/> Not use			
Authentication	Digest or Basic						
Set							
User name registration	--New registration--			Change		Delete	
User name (1 to 32 characters)							
Password (8 to 32 characters)							
Retype password							
Access level	3. Live only						
Set							

User registration screen of Network camera

0

Setup to Registration

1

Registration of Recorder

2

Registration of Camera and Encoder

Registration of Recorder (1/4)

37

Step 1 Run "Panasonic Security Viewer", and Tap "Setting" button , and display the connecting device setting screen.

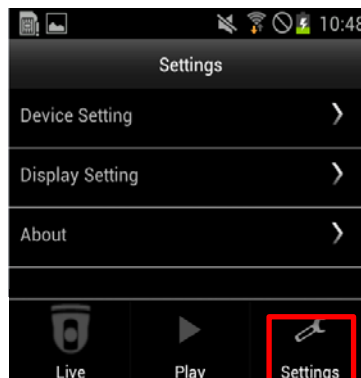
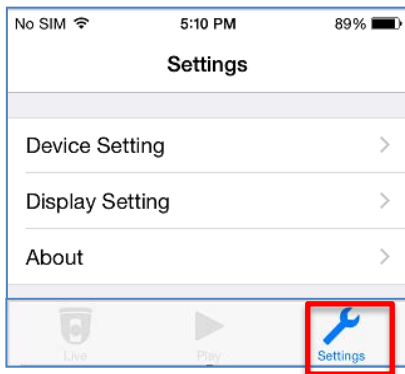

Step 2 Please, Tap "+" button.

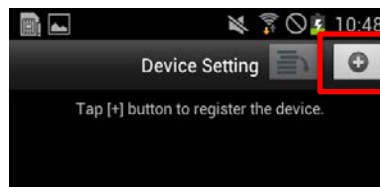
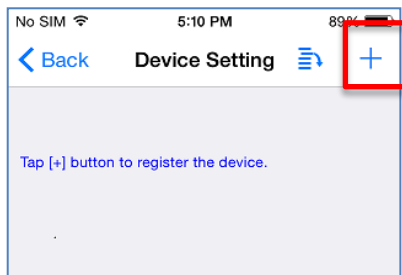

Registration of Recorder (2/4)

38

Step 3 After you register the recorder information, tap “Set” button.
Please see the next page about setting items.

No SIM 5:10 PM 89%

< Device Setting Device Regist... Set

Name Max 16 characters

Device Type Recorder >

Address http:// Host/IP

Port Num Port number

User Name User Name

Password Password

Live Setting >

Device Registration Set

Name Max 16 characters

Device Type Recorder >

Address http://Host/IP

Port Num Port Num

User Name User Name

Password Password

Settings

Live Setting >

Registration of Recorder (Input value explanation) (3/4)

39

Item		Input Value
Name		Input the displayed name of a recorder (Up to 16 characters)
Device Type		Select "Recorder"
Address		1) via Internet : Input the URL of DDNS which set on a recorder or "fixed" global IP address of a router. 2) via Wi-Fi : Input the recorder's local IP address.
Port Num		1) via Internet : Input the port number of the port forwarding of the recorder which set on the router. 2) via Wi-Fi : Input the port number of a recorder.
User name		Input an access user which registered on recorder
Password		Input a password of the access user which registered on recorder
Live Setting	Frame Rate Setting	Select the frame rate at the time of a live display.
	Resolution Setting	Select the resolution at the time of a live display.
	Connection Setting	Select "Via Recorder"
Playback Setting	Playback Mode Setting	Select the playback mode.

Registration of Recorder (4/4)

40

Step 4 Finished the recorder setting.

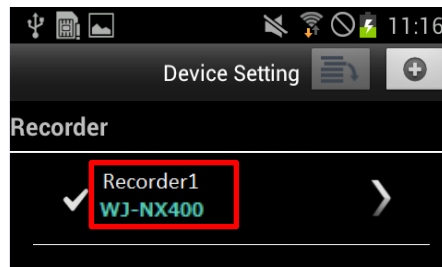
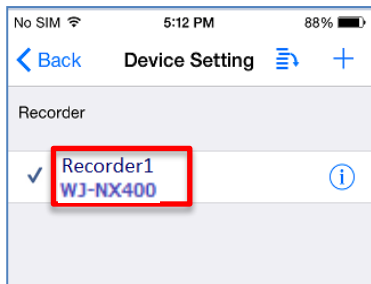

Step 5 Tap “Back” button, and back the "Setting" screen.

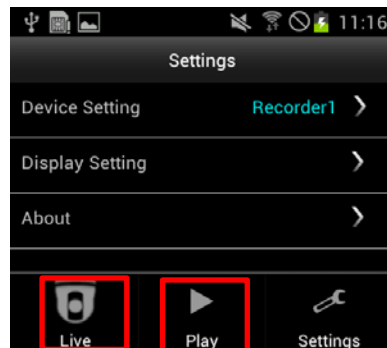
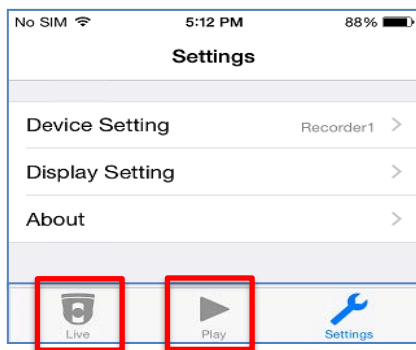

Let's start monitoring, please tap “Live” or “Play” Button.

0

Setup to Registration

1

Registration of Recorder

2

Registration of Camera and Encoder

Registration of Camera and Encoder (1/4)

42

Step 1 Run "Panasonic Security Viewer", and Tap "Settings" button , and display the connecting device setting screen.

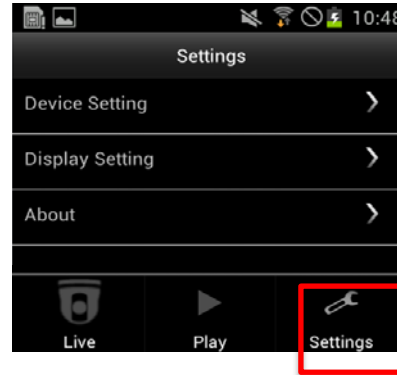
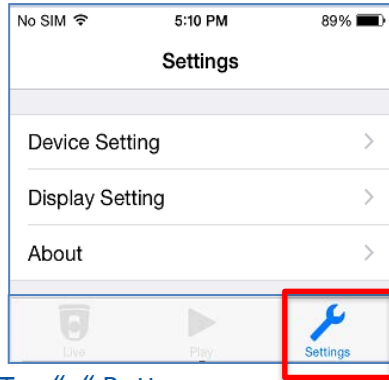

Step 2 Please, Tap "+" Button.

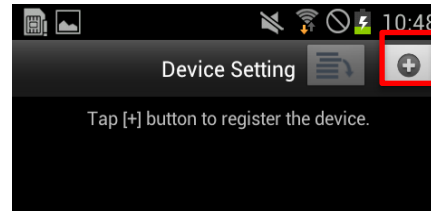
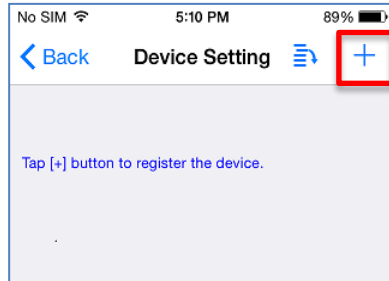

Registration of Camera and Encoder (2/4)

43

Step 3 After you register the camera / encoder information, tap “Set” button.
Please see the next page about setting items.

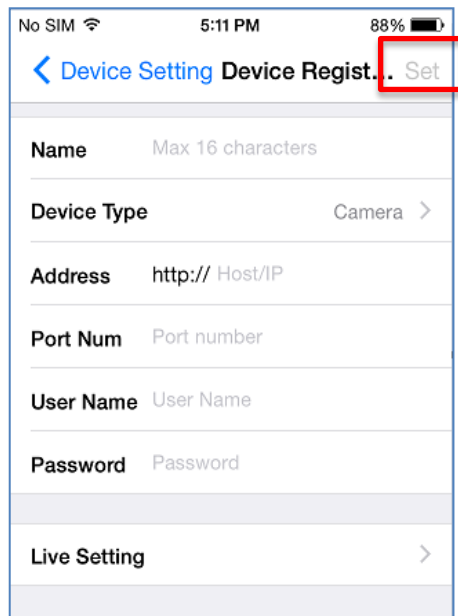

No SIM 5:11 PM 88%

< Device Setting Device Regist... Set

Name Max 16 characters

Device Type Camera >

Address http:// Host/IP

Port Num Port number

User Name User Name

Password Password

Live Setting >

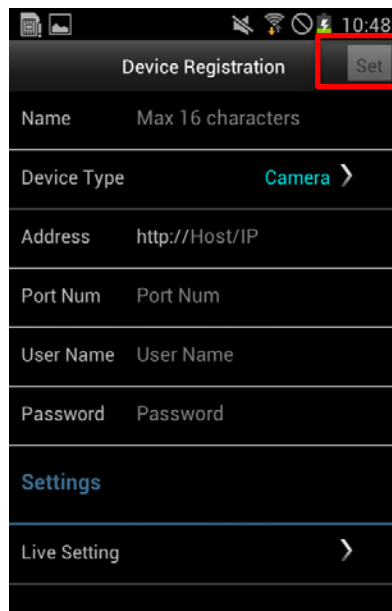

Device Registration Set

Name Max 16 characters

Device Type Camera >

Address http://Host/IP

Port Num Port Num

User Name User Name

Password Password

Settings

Live Setting >

Registration of Camera and Encoder (Input value explanation) (3/4) 44

Item		Input Value
Name		Input the displayed name of a camera / encoder.
Device Type		Select "Camera" or "Encoder".
Address		1) via Internet: Input the URL of DDNS which set on a camera / encoder or "fixed" global IP address of a router. 2) via Wi-Fi : Input the camera/encoder's local IP address.
Port Num		1) via Internet : Input the port number of the port forwarding of the camera/encoder which set on the router. 2) via Wi-Fi : Input the port number of a camera / encoder.
CH		Select the channel number to which the target camera is connected *This item is appeared only when an encoder is selected on the device type screen.
User Name		Input an access user for using Panasonic security viewer which registered on the camera / encoder.
Password		Input a password of the access user.
Live Setting	Frame Rate Setting	Select the frame rate at the time of a live display.
	Resolution Setting	Select the resolution at the time of a live display.

Registration of Camera and Encoder (4/4)

45

Step 4 Finished the camera/encoder setting.

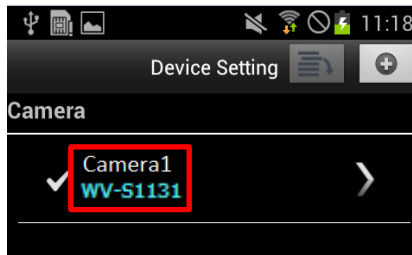
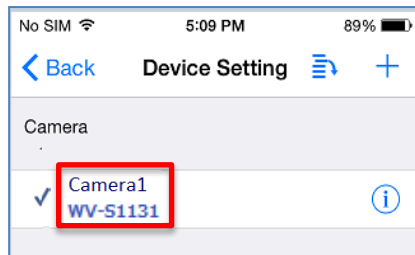

Step 5 Tap “Back” Button, and back the "Setting" screen.

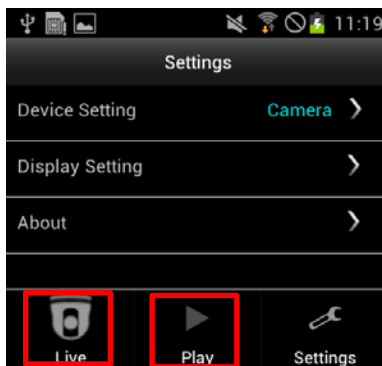
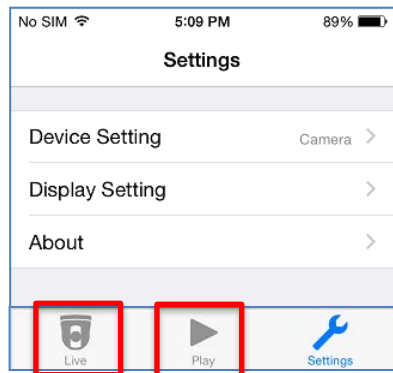

Let's start monitoring, please tap “Live” Button or “Play” Button.

FAQ

Connecting Panasonic recorder / camera directly

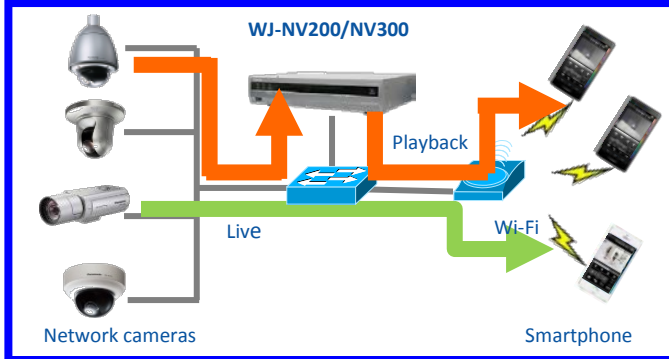

Step 1 Select "Direct Camera Access" on "Connection Setting" item of "Live Setting" screen.

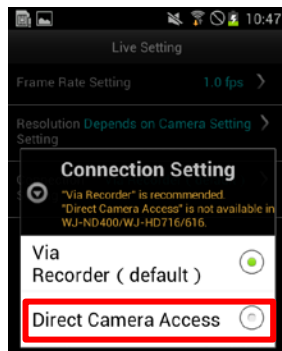
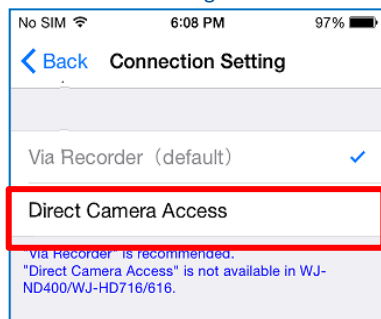

[Phenomenon] When setting "**Via Recorder**" on "Connection Setting" item of "Live Setting", Multiple smartphone cannot view live of same camera .

[Cause] When setting "Via Recorder" , only one user can view live of one camera. This is limitation of WJ-NV200/NV300 .

[Behavior]

When smartphone(1) view live of camera(1) , Then smartphone(2) views live of camera(1).

Smartphone(2) can view live of camera(1).

Smartphone(1) will not view live of camera(1). (Screen changes black.)

Please refer slid of Accessible user (Live) (1/3 -3/3).

[Countermeasure] Select "**Direct Camera Access**" on "Connection Setting" item of "Live Setting" screen.

[Note] Normally, you will not have this issue because WJ-NX400/NX200/NX300 are up to 13 for same camera by "**Via Recorder**" setting.

Note:

"Direct Camera Access" is used **only Local Network (LAN/Wi-Fi)**.

[Phenomenon] When setting **"Via Recorder"** on "Connection Setting" item of "Live Setting", You can not view live stream of camera when resolution of camera is 1920x1080 or more.

[Cause] This is limitation of Panasonic network recorder.

[Countermeasure]

- 1) When you do not want to change the resolution of camera,
Select **"Direct Camera Access"** on "Connection Setting" item of "Live Setting" screen.
- 2) When you can change resolution of camera
Change the resolution of camera to 1920x1080 or less.

Can not playback by using Mobile Mode

49

[Phenomenon]

- 1) **WJ-NV300** can not playback by using Mobile Mode if camera resolution is set to QXVGA (2048x1568) or higher.
- 2) **WJ-NX400** can not use playback by using Mobile Mode if you register extension license (96CH / 128CH) or secure extended license to WJ-NX400.
- 3) **WJ-NX400/NX200/NX300** can not use playback by using Mobile Mode if you register secure extended license to WJ-NX400/NX200/NX300.

[Cause]

- 1) By the default setting of WJ-NV300, it is not be able to playback stored date of camera resolution of QXVGA (2048x1568) or higher.
- 2) Issue of Extension License (96CH / 128CH) restriction is limitation of WJ-NX400.
- 3) Issue of Secure extended license restriction is limitation of WJ-NX400/NX200/NX300.

[Countermeasure]

- By Web setting screen of the recorder, select in order of "Setup" -> "Monitor" -> "Advanced setup" tab, and check "Enable re-encoding ..." of "Other setup" area and set.
- > WJ-NV300 can playback by using Mobile Mode if camera resolution is set to QXVGA (2048x1568) or higher.
- 2) Currently, there is no countermeasure.
 - 3) Currently, there is no countermeasure.

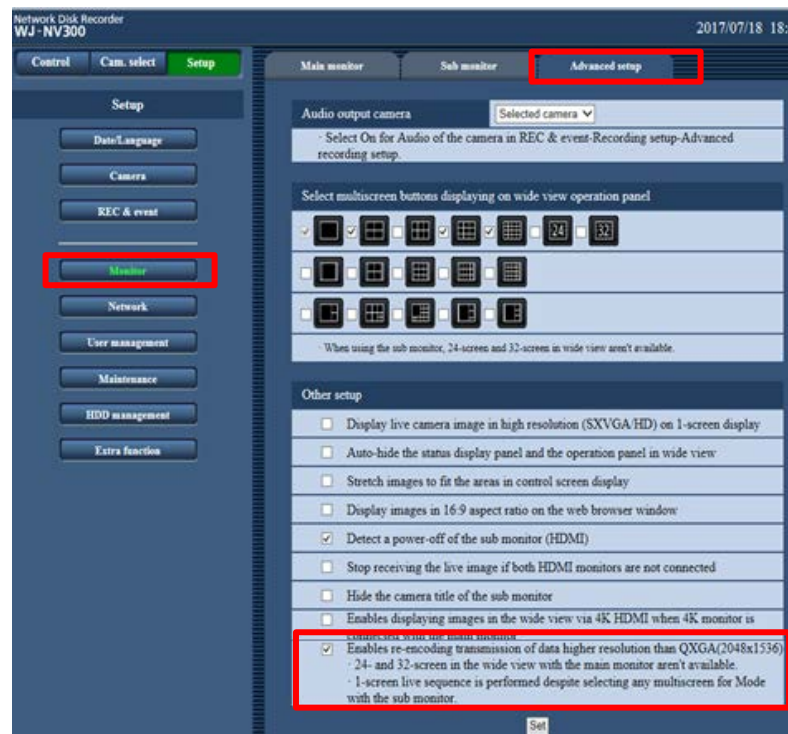

Monitor -> Advanced setup screen of WJ-NV300



Thank you

