

New functions and addendum

- This document contains descriptions of how to set the new functions and their restrictions. Refer also to the Operating Instructions of this product.
- Depending on the model used, the screens shown in the explanations may differ to the actual camera screens.
- This document is for the following models.
WV-S1572L, WV-S2572L, WV-S2272L, WV-S1552L, WV-S2552L, WV-S2252L

•Firmware Ver.1.50

No.	Functions	Item (Page)	Page
1	Add a notify to the [SNMP trap setting]	Advanced (Network)	2
2	Add to the system log when recording stream fails to write	Maintenance (Status)	3
3	Add a function to notify the user of writing failures in the recording stream with a unique alarm	Notification (Alarm)	4
4	Add a note when the bit rate of the recording stream is set to a value exceeding recommended value	Image/Audio (Image)	5
5	Extend authentication password for the destination of notification	Network (Advanced)	6

•Firmware Ver.1.51

No.	Functions	Item (Page)	Page
6	Add LLDP function	Advanced (Network)	7

1. Add a notify to the [SNMP trap setting] **(Operating Instructions Configure the network settings [Network] - Configure advanced network settings [Advanced])**

Add the notifications to [SNMP trap settings].

Note

- In order to activate SNMP trap notifications for when alarms occur, alarm operation settings are required.
For information on settings related alarm operations, refer to Configure the alarm settings [Alarm] in Operating Instructions.

2. Add to the system log when recording stream fails to write

(Operating Instructions “Others” – “Maintenance” - Check the status [Status])

A system log has been added for errors in the write process of the recording stream to the log related to SD memory cards.

Category	Indication	Description
SD memory card	<SD>Format	Successfully formatted the SD memory card.
	<SD>Format error	Error occurred when formatting the SD memory card.
	<SD> Write-protect ON (Locked card)	A write-protected SD memory card is inserted.
	<SD> Detection error	The SD memory card could not be correctly recognized.
	<SD> Write error	An error occurred when writing to the SD memory card.
	<SD> Read error	An error occurred when reading from the SD memory card.
	<SD> Delete error	An error occurred when deleting data from the SD memory card.
	<SD> File system error	An error occurred in File system of the SD memory card.
	<SD> Undefined error	An error other than the ones above has occurred for the SD memory card.
	<SD> An abnormality occurs in continuity of the SD memory recording. Check the recording bit rate setting of the SD memory recording.	An error occurred when writing to the SD memory card.
<SD> An error occurs in the SD memory card. Check the status of the SD memory card.	The SD memory card write process still generates data loss. Make sure that the SD memory card is properly recognized. If the card is not recognized, reboot the unit, or remove and reinsert the SD memory card to check.	

3. Add a function to notify the user of writing failures in the recording stream with a unique alarm

(Operating Instructions “Others” – “Maintenance” - Configure the alarm settings [Alarm])

– Configuration of the settings relating to alarm notification [Notification] –

Configure the settings relating to Panasonic alarm protocol)

Add the write processing error of the recording stream to the occurrence condition of the Panasonic alarm protocol notification of “Diag.”

Panasonic alarm protocol

• [Panasonic alarm protocol]

Select “On” or “Off” to determine whether or not to provide notification by Panasonic alarm protocol according to the settings for the “Alarm” and “Diag.” checkboxes of “Destination of notification” below.

- When an alarm is detected (“Alarm”)
- When a notification of the remaining capacity of the SD memory card has been provided (“Diag.”)
- When the SD memory card has become full (“Diag.”)
- When the SD memory card cannot be recognized (“Diag.”)
- When there is a write error on the SD memory card (“Diag.”)

Default: Off

Destination of notification

• [Address 1] - [Address 8]

Enter the destination IP address or host name of the Panasonic alarm protocol from the following.

Up to 8 destination server addresses can be registered.

[Alarm] checkbox: When the checkbox is checked, the Panasonic alarm notification will be provided upon an alarm occurrence.

[Diag.] checkbox: When the checkbox is checked, notification using Panasonic alarm protocol will be provided in the following cases.

- When notification of the remaining capacity of the SD memory card has been provided
- When the SD memory card has become full
- When the SD memory card cannot be recognized
- When the SD memory card cannot be written

[Destination server address]: Enter the destination server address or host name.

Available characters: Alphanumeric characters, the colon (:), the period (.), the underscore (_), and the hyphen (-).

To delete the registered destination server address, click the [Delete] button respective to the desired destination server address.

4. Add a note when the bit rate of the recording stream is set to a value exceeding recommended value

(Operating Instructions “Image/Audio” - Configure the settings relating to Stream [Image])

Add the statement that it is possible that an error may occur in the continuity of SD memory card recording, if you set a bit rate that exceeds the recommended value in “Note” of “Max bit rate (per client) *”.

[Max bit rate (per client)*]:

Note

- The bit rate for “Stream” is restricted by “Bandwidth control (bit rate)” on the [Network] tab on the “Network” page. When a value with “*” attached is set, images may not be streamed.
- It is recommend that the bit rate setting of the stream to be 8192 kbps or lower. Setting a value higher than 8192 kbps may cause abnormalities in the continuity of the recorded video.
- When the refresh interval is too short, the actual bit rate may exceed the set bit rate depending on the subject.
- Depending on the number users connecting at the same time or the combination of features used, the bit rate may be lower than the configured value. Check the transmission of images after changing settings.

5. Extend authentication password for the destination of notification (Operating Instructions – Configure the network settings [Network] – Configure advanced network settings [Advanced] - Configure the settings related to sending E-mails)

The number of characters that can be entered for the authentication password of the destination of notification has been expanded to 128 characters.

- **[Authentication – Password]**

Enter the password to access the server.

Available number of characters: 0 - 128 characters

Unavailable characters: " &

6. Add LLDP function

(Operating Instructions – Configuring the network settings [Network] – Configure advanced network settings [Advanced])

LLDP (Link Layer Discovery Protocol) has been added to [Advanced] of [Network]. Interoperability can be achieved by sending and receiving camera's device information to and from LLDP-compatible devices.

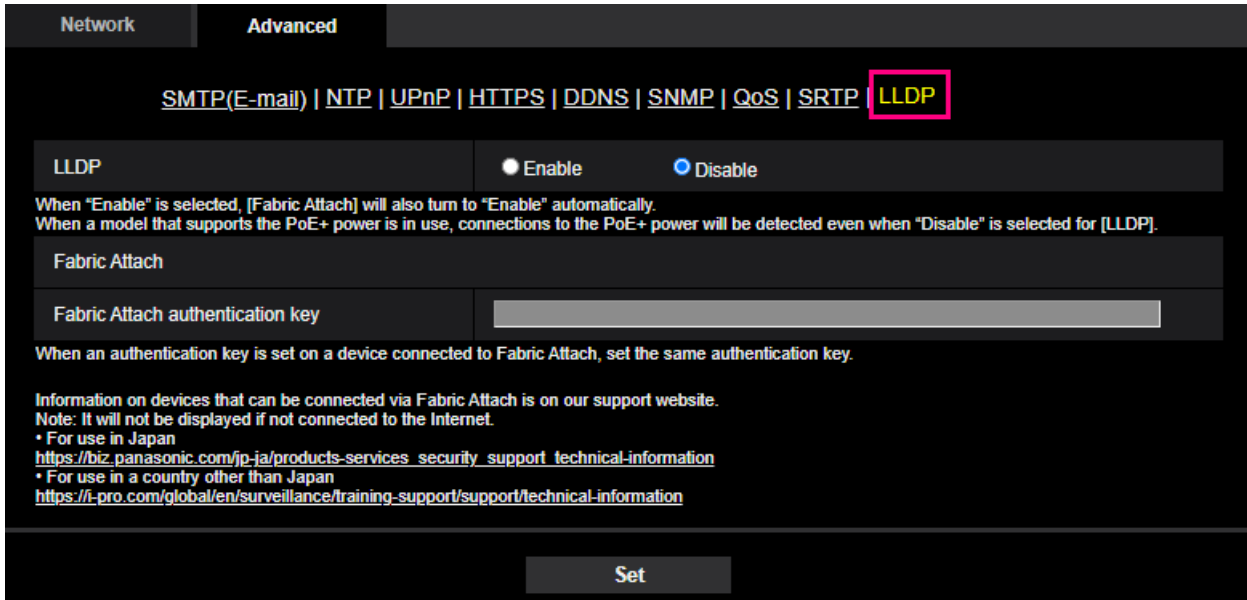

[LLDP]

Enable/Disable whether to enable the LLDP function and Fabric Attach.

Default: Disable

When set to “Enable”, LLDP including TLVs with the checks in the table below will be sent.

End Of LLDAPDU TLV	Chassis ID TLV	Port ID TLV	Time To Live TLV	Port Description on TLV	System Name TLV	System Description on TLV	System Capability TLV	Management Address TLV	IEEE802.3 Power via MDI TLV	Fabric Attach Element TLV
✓	✓	✓	✓	✓	✓	✓	✓	✓	✓	✓

* Models that support PoE+ power supply will send LLDP including TLVs with the checks in the table below for PoE+ power supply even if set to “Disable”.

End Of LLDAPDU TLV	Chassis ID TLV	Port ID TLV	Time To Live TLV	Port Description on TLV	System Name TLV	System Description on TLV	System Capability TLV	Management Address TLV	IEEE802.3 Power via MDI TLV	Fabric Attach Element TLV
✓	✓	✓	✓						✓	

Fabric Attach

[Fabric Attach authentication key]

Enter the key to be used for Fabric Attach authentication. Note that this is valid only when “LLDP” is “Enable”.

Available number of characters: 0 - 32 characters (If Fabric attach authentication is not performed, leave it blank.)

Available characters: Alphanumeric characters

Default: None (blank)

Note

- Click the [Set] button to restart the product. After restarting, the product cannot be operated for about 2 minutes, just like when the power is turned on.
- For information about devices that can be connected using Fabric Attach, refer to our support website.
<https://i-pro.com/global/en/surveillance/training-support/support/technical-information>