



Installation Guide

Included Installation Instructions

Network Camera

For professional use only

Model No. WV-X5550LT

Outdoor use

WV-X5550LTPJ

Outdoor use

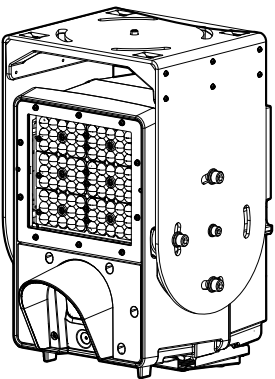

About the user manuals

Product documentation is composed of the following documents.

- **Installation Guide (this document):** Provides information about "Precautions", "Precautions for installation" and the installation method.
- **Basic Information (in the following website):** Provides information about "Precautions for use" and "Detail specifications".
- **Operating Instructions (in the following website):** Explains how to perform the settings and how to operate this camera.

<https://i-pro.com/library/vcc/>



"<Control No.: C*****>" used in these documents should be used to search for information on our support website (https://i-pro.com/global/en/surveillance/training_support/support/technical_information) and will guide you to the right information.



- Before attempting to connect or operate this product, please read these instructions carefully and save this manual for future use.
- The external appearance and other parts shown in this manual may differ from the actual product within the scope that will not interfere with normal use due to improvement of the product.

For U.S. and Canada:

i-PRO Americas Inc.

<https://www.i-pro.com/>

For Europe and other countries:

i-PRO Co., Ltd. Fukuoka, Japan
<https://www.i-pro.com/>

i-PRO EMEA B.V. UK Branch
1010 Cambourne Business Park,
Cambridgeshire CB23 6DP

Authorised Representative in EU:
i-PRO EMEA B.V.
Laarderhoogtweg 25, 1101 EB
Amsterdam, Netherlands



© i-PRO Co., Ltd. 2022

CSH0720-2042
Printed in Japan

Disposal of Old Equipment and Batteries

Only for European Union and countries with recycling systems

These symbols on the products, packaging, and/or accompanying documents mean that used electrical and electronic products and batteries must not be mixed with general household waste. For proper treatment, recovery and recycling of old products and used batteries, please take them to applicable collection points in accordance with your national legislation. By disposing of them correctly, you will help to save valuable resources and prevent any potential negative effects on human health and the environment.

For more information about collection and recycling, please contact your local authority. Penalties may be applicable for incorrect disposal of this waste, in accordance with national legislation.

Note for the battery symbol (bottom symbol)

This symbol might be used in combination with a chemical symbol. In this case it complies with the requirement set by the Directive for the chemical involved.

For U.S.A.

NOTE: This equipment has been tested and found to comply with the limits for a Class A digital device, pursuant to Part 15 of the FCC Rules. These limits are designed to provide reasonable protection against harmful interference when the equipment is operated in a commercial environment. This equipment generates, uses, and can radiate radio frequency energy and, if not installed and used in accordance with the instruction manual, may cause harmful interference to radio communications. Operation of this equipment in a residential area is likely to cause harmful interference in which case the user will be required to correct the interference at his own expense.

FCC CAUTION: Changes or modifications not expressly approved by the party responsible for compliance could void the user's authority to operate the equipment.

Supplier's Declaration of conformity

Trade name : i-PRO
Model No. : WV-X5550LT/WV-X5550LTPJ
Responsible Party :
i-PRO Americas Inc.
8550 Fallbrook Drive, Suite 200 Houston,
Texas 77064
Support Contact : 1-800-513-5417



For U.S.A.

The model number and serial number of this product may be found on the surface of the unit. You should note the model number and serial number of this unit in the space provided and retain this book as a permanent record of your purchase to aid identification in the event of theft.
Model No. _____
Serial No. _____

For Canada

CAN ICES-3(A)/NMB-3(A)

Méthode d'installation	Vis de fixation recommandée	La capacité de traction minimale requise
Monter la caméra vidéo sur le sol, le plafond ou le pôle.	M10 x 55 mm [2-5/32 pouces] / 4el.	1539 N [346 lbf] (per 1 pc.)

For U.S.A. and Canada

This device complies with part 15 of FCC Rules and Innovation, Science and Economic Development Canada's licence-exempt RSS(s). Operation is subject to the following two conditions : (1) This device may not cause harmful interference, and (2) this device must accept any interference received, including interference that may cause undesired operation.

Le présent appareil est conforme à la partie 15 des règles de la FCC et aux normes des CNR d'Innovation, Sciences et Développement économique Canada applicables aux appareils radio exempts de licence. L'exploitation est autorisée aux deux conditions suivantes : (1) l'appareil ne doit pas produire de brouillage, et (2) l'appareil doit accepter tout brouillage subi, même si le brouillage est susceptible d'en compromettre le fonctionnement.

Pour les États-Unis et le Canada

La longueur des vis correspond à la longueur à laquelle les écrous, les rondelles et les rondelles élastiques sont fixés des deux côtés de tôles d'acier de 20 mm [25/32 pouces] d'épaisseur. La longueur des boulons varie en fonction du lieu d'installation.

WARNING:

- This equipment is compliant with Class A of CISPR 32. In a residential environment this equipment may cause radio interference.
 - Operation of this equipment in a residential environment could cause radio interference.
 - Only connect 24 V AC Class2 power supply (UL 1310/CSA 223) or limited power source (IEC/EN/UL/CSA 60950-1 or IEC/EN/UL/CSA 62368-1 Annex Q).
 - Before attempting to connect or operate this product, please read these instructions carefully.
- NOTICE:**
- This product is not suitable for use in locations where children are likely to be present.
 - Do not install this product in locations where ordinary persons can easily reach.
 - This product is a professional equipment.
 - For information about screws and other parts required for installation, refer to the corresponding section of this document.

~ : Alternating current symbol

RISK GROUP2 CAUTION
IR emitted from this product.
Avoid eye exposure.
Use appropriate shielding or eye protection

Precautions

Do not insert any foreign objects.

Fire or electrical shock may be caused if water or any foreign objects, such as metal objects, enter inside the unit. Turn the power off immediately and contact qualified service personnel for service.

Do not use this product in an inflammable atmosphere.

Failure to observe this may cause an explosion resulting in injury.

Avoid installing this product in the locations where salt damage occurs or corrosive gas is produced.

Otherwise, the mounting portions will deteriorate and injury or accidents due to a fall of the product may occur.

Do not strike or give a strong shock to this product.

Failure to observe this may cause injury or accidents.

Do not hang down from this product or use this product as a pedestal.

Failure to observe this may cause injury or accidents.

Do not damage the power cable.

Do not damage, fabricate, twist, stretch, bundle, or forcibly bend the power cable. Do not place heavy objects on it, and keep it away from heat sources. Use of a damaged power cable may cause electric shock, short circuit, or fire. Consult the dealer for repair.

Do not install this product on a place that is greatly influenced by wind.

Installation on a place where the wind speed is 60 m/s (approx. 134 mph) or more may cause a fall of the product resulting in injury or accidents.

Do not sprinkle more water, exceeding the performance limit of waterproof with a high pressure cleaning machine, etc.

Fire or electrical shock may be caused by immersion.

Do not attempt to disassemble or modify this product.

Failure to observe this may cause fire, electric shock or a drop resulting in injury or accidents. Consult the dealer for the repair or inspections.

Do not install or clean the camera, or touch this product, the power cable or the connected cables during thunder storms.

Failure to observe this may cause electric shock.

Refer installation work to the dealer.

Installation work requires technique and experience. Failure to observe this may cause fire, electric shock, injury, or damage to the product. Be sure to consult the dealer.

Entrust any work in high places to qualified service personnel.

Installation work requires technique and experience. Failure to observe this may cause fire, electric shock, injury, or damage to the product. Be sure to consult the dealer.

Stop the operation immediately when something is wrong with this product.

When smoke goes up from the product, the smell of smoke comes from the product, or the exterior of the product has deteriorated, continued use will cause a fire or fall of the product resulting in injury, or damage to the product. In this case, turn the power off immediately and contact qualified service personnel for service.

Select an installation area that can support the total weight.

Selecting an inappropriate installation surface may cause this product to fall down or topple over, resulting in injury or accidents. Installation work shall be started after sufficient reinforcement.

Periodic inspections shall be conducted.

Rust on the metal parts or screws may cause a fall of the product resulting in injury or accidents. Consult the dealer for the inspections.

The exclusively designed mount bracket shall be used.

Failure to observe this may cause a drop resulting in injury or accidents. Use the exclusively designed mount bracket for installation.

The screws and bolts must be tightened to the specified torque.

Failure to observe this may cause a drop resulting in injury or accidents.

Install this product in a location high enough to avoid vehicles and objects from bumping the product.

Failure to observe this may cause injury.

Turn the power off when do wiring of this product.

Failure to observe this may cause electric shock. In addition, short circuit or wrong wiring may cause fire.

The measures of protection against a fall of this product shall be taken.

Failure to observe this may cause a drop resulting in injury or accidents. Be sure to install the safety wire.

Do not install this product in locations subject to continuous or large vibration.

Loosening of mounting screws or bolts may cause a fall of the product resulting in injury or accidents.

Do not install this product in a place that is easily exposed to oil.

Otherwise, the mounting portions may deteriorate and thus the product may fall down, resulting in injury or accidents.

Correctly perform all wiring.

Short circuits in the wiring or incorrect wiring may cause fire or electrical shock.

Do not install beneath areas where layers of snow could fall.

Failure to observe this may cause a drop resulting in injury or accidents.

The measures of protection against snowfall shall be taken.

Weight of snow may cause a fall of the product resulting in injury or accidents. Protect the product against snowfall by installing it under eaves.

Install the product securely on an installation area in accordance with the installation instructions.

Failure to observe this may cause injury or accidents.

Do not rub the edges of metal parts with your hand.

Failure to observe this may cause injury.

Do not look directly at the light-emitting part of IR LEDs.

Failure to observe this may cause damage to eyesight. Use appropriate shielding or eye protection.

Turn the power off when cleaning this product.

Failure to observe this may cause electric shock.

Always inspect after an earthquake.

The mounting portions on the main body may be damaged and a fall may occur. Be sure to consult the dealer.

Do not touch the lighting parts on the top part of devices.

The lighting parts may become hot. Directly touching these parts may cause burns.

Be careful when installing this product.

Dropping this product on your foot may cause injury.

Do not use this product as a footstool or bench.

Failure to observe this may cause injury.

Do not install this product in a place where the temperature can get abnormally high.

Parts may deteriorate, resulting in fire.

Do not apply excessive force.

Otherwise, front portion may get damaged, resulting in injury or accidents.

Open Source Software

- This product contains open source software licensed under GPL (GNU General Public License), LGPL (GNU Lesser General Public License), etc.
- Customers can duplicate, distribute and modify the source code of the software under license of GPL and/or LGPL.
- For details concerning licensing and source code of open source software, click "Click here for OSS information" on the "Support" page of the setup menu of the camera and read the displayed content.
- Please note that we shall not respond to any inquiries regarding the contents of the source code.

Copyright

Except for open source software licensed under GPL/LGPL and so on, distributing, copying, disassembling, reverse compiling and reverse engineering of the software provided with this product are all expressly prohibited. In addition, exporting any software provided with this product violating export laws is prohibited.

Trademarks and registered trademarks

- Microsoft, Windows, Windows Media, Internet Explorer, Microsoft Edge, and ActiveX are either registered trademarks or trademarks of Microsoft Corporation in the United States and/or other countries.
- Intel and Intel Core are trademarks of Intel Corporation or its subsidiaries in the U.S. and/or other countries.
- Adobe, Acrobat, and Reader are either registered trademarks or trademarks of Adobe in the United States and/or other countries.
- iPad and iPhone are trademarks of Apple Inc., registered in the U.S. and other countries.
- Android and Google Chrome are trademark of Google LLC.
- Firefox is a trademark of the Mozilla Foundation in the US and other countries.
- The word "QR Code" is a registered trademark of DENSO WAVE INCORPORATED in Japan and other countries.
- All other trademarks identified herein are the property of their respective owners.

Covered by one or more claims of the HEVC patents listed at patentlist.accessadvantage.com.

Precautions for installation

i-PRO Co., Ltd. assumes no responsibility for injuries or property damage resulting from failures arising out of improper installation or operation inconsistent with this documentation.

In order to prevent injury, the product must be securely mounted to an installation area according to Installation Guide.

Installation area for this product

Select an appropriate place for the installation area in your particular environment.

- Make sure that the installation area is strong enough to hold this product, such as a concrete ceiling.

- Install the camera in the foundation area of the architecture or where sufficient strength is assured.
- Do not mount the product on a plaster board or a wooden section because they are too weak. If the product is unavoidably mounted on such a section, the section shall be sufficiently reinforced.

Do not place this product in the following places.

- Locations where a chemical agent is used.
- Locations subject to moisture or oil smoke such as a plant.
- Locations that have a specific environment that is subject to an inflammable atmosphere or solvents.
- Locations where a radiation, an X-ray, a strong radio wave or a strong magnetic field is generated.
- Locations near coasts directly subjected to sea breezes, or locations subject to corrosive gases such as from hot springs, volcanic regions, etc.
- Locations where the temperature is not within the specified range.
- Locations subject to vibrations, such as on vehicles, marine vessels, or above product lines (This product is not designed for on-vehicle use.)
- Locations subject to condensation as the result of severe changes in temperature (In case of installing the product in such locations, the front panel may become foggy or condensation may be caused on the panel.)
- Locations near rubber products (packing, rubber feet, etc.)

Screw tightening

Do not use an impact driver. Use of an impact driver may damage the screws or cause tightening excessively.

About reflection of light from outside or IR light

Depending on the incident angle of external light, a ghost may appear on the screen. In the case of using the IR light, installation of a camera near a wall may cause reflection of infrared rays resulting in a part of the screen or the entire screen turning whitish.

- Refer to our support website <Control No.: C0109> for image examples and measures to take.

Take notice of humidity

Install this product when the humidity is low. If installation is performed when it is raining or in very humid conditions, the inside may be affected by humidity, causing mist-over inside the front panel.

Protection from lightning

When cables are used outdoors, there is a chance that they may be affected by lightning. In such a case, install a lightning arrestor close to the camera, and make the length of the network cable between the camera and lightning arrestor as short as possible to prevent the camera from being affected by lightning.

Grounding connection of the lightning arrestor

With the TILT bracket connected to the earth ground, connect the ground of the lightning arrestor (locally procured) to the right location of this unit. Procure locally all the screws used for connecting. Recommended fixing screws: M3x8 mm [5/16 inches] with spring washer.

When noise disturbance may happen

Noise may appear in video or audio near a strong electric field from a TV or radio antenna, motors and transformers, or a strong electric field/magnetic field from a power line (lamp line) of AC100 V or more. Conduct the power distribution work to keep 1 m {3.28 ft} away from them or conduct the electric conduit work using metal pipes. (Be sure to make ground connection of the metal pipes.)

Make sure to remove this product if it will no longer be used.

This product has no power switch.

When turning off the power, disconnect the power supply from the 24 V AC power supply.

About the battery

A battery is installed inside the camera. Do not leave the battery exposed in environments of excessive heat as a result of sunlight or fire.

Equipment classification and power source indication label

Refer to the indication label on the bottom side of this unit for the equipment classification, power source, and other information.

Troubleshooting

Before requesting service, refer to "Troubleshooting" of Basic Information and Operating Instructions on the manual website. Then, confirm the trouble.

Specifications* *For further information, refer to the Basic Information.

Basic

Power source *1:	AC 24 V (50 Hz/60 Hz)
Power consumption *1:	AC 24 V : 3.8 A /Approx. 68 W
Operating environment Ambient operating temperature:	-40 °C to +60 °C [-40 °F to +140 °F] (Power On range: -20 °C to +60 °C [-4 °F to +140 °F])
Ambient operating humidity:	10 % to 100 % (no condensation)
Storage environment Storage temperature: Storage humidity:	-30 °C to +60 °C [-22 °F to +140 °F] 10 % to 95 % (no condensation)
Waterproof *2:	IP66 (IEC 60529), Type 4X (UL50E) NEMA 4X compliant
Shock resistance:	IK10 (IEC 62262) (Except for front panels)
Wind resistance:	Up to 40 m/s (approx. 89 mph)
Dimensions:	Ceiling mount: 303 mm {11-15/16 inches} (W), 475 mm {18-11/16 inches} (H), 368 mm {14-1/2 inches} (D) Pole mount: 303 mm {11-15/16 inches} (W), 396 mm {15-19/32 inches} (H), 458 mm {18-1/32 inches} (D) Stationary mount: 303 mm {11-15/16 inches} (W), 440 mm {17-5/16 inches} (H), 368 mm {14-1/2 inches} (D)
Mass:	Main body: Approx. 11.5 kg [25.39 lbs] With TILT bracket: Approx. 16.0 kg [35.32 lbs]
Finish:	Main body: Aluminum die cast, Silver Glass and Polycarbonate resin, Clear Outer fixing screws: Stainless steel (Corrosion-resistant treatment) TILT bracket: Aluminum plate and Aluminum die cast, Silver

*1 Refer to our support website <Control No.: C0106> for further information about Power source and Power consumption information.

*2 Only when installation work is properly performed according to the Installation Guide and appropriate waterproof treatment is performed.

Standard accessories

Installation Guide (this document) 1 pc. Code label*1 1 pc.
IMPORTANT SAFETY INSTRUCTIONS..... 1 pc.

*1 This label may be required for network management. Use caution not to lose this label.

The following parts are used during installation procedures.

Waterproof tape.....	1 pc.	RJ45 waterproof connector cover	1 pc.
Safety wire.....	1 pc.	RJ45 waterproof connector cap	1 pc.
24 V AC power supply connector kit.....	1 set	Hexagon screw (M10 x 20 mm) [25/32 inches]	
(Power supply connector housing: 1 pc., Contact: 3 pcs.)			6 pcs. (of them, 1 for spare)
Cable cover.....	1 pc.	Bit (Hex wrench, screw size 6.35 mm [1/4 inches] T20)	
		1 pc.

Other items that are needed (not included)

① Wi-Fi USB adapter (locally procured)

Be sure to use a Wi-Fi USB adapter that is checked its operability. Refer to our support website <Control No.: C0114> for operation check information of Wi-Fi USB adapter.

② M10 bolts and nuts with washers and spring washers (4 sets) (locally procured)

Installation method	Recommended screw*1	Minimum pull-out strength*2
Mount the camera onto the floor, ceiling or pole.	M10 x 55 mm [2-5/32 inches]*3 / 4 pcs.	1539 N [346 lbf] (per 1 pc.)

*1 Select screws according to the material of the location that the camera will be mounted to. In this case, wood screws and nails should not be used.

*2 For information about the minimum pull-out strength, refer to our support website <Control No.: C0120>.

*3 The length of screws is the length for when bolt nuts, washers, and spring washers are fixed to both sides of 20 mm [25/32 inches] thick steel sheets. The length of bolts differs depending on the installation location.

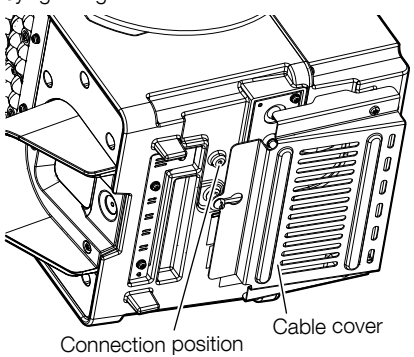

Parts and functions

- A part of the cable cover is omitted in the following illustrations.

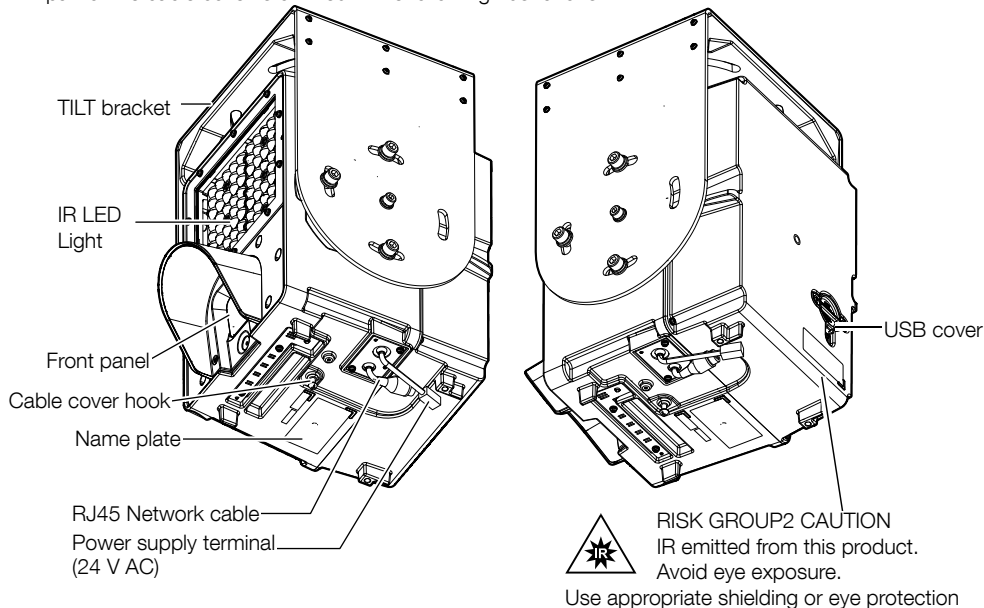

Installations

[1] Limitations for the installation location

Please meet the following conditions for the camera installation.

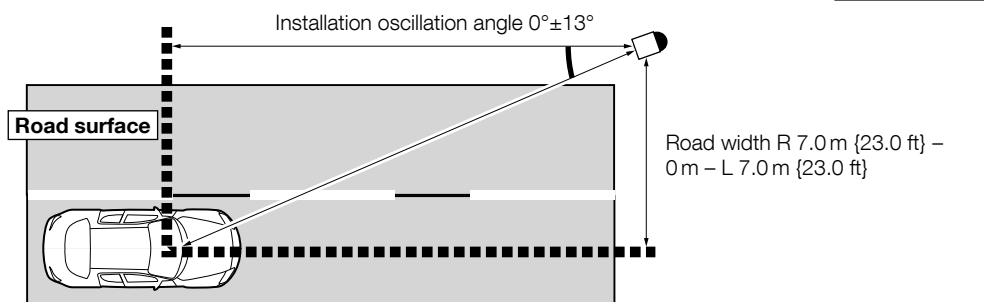
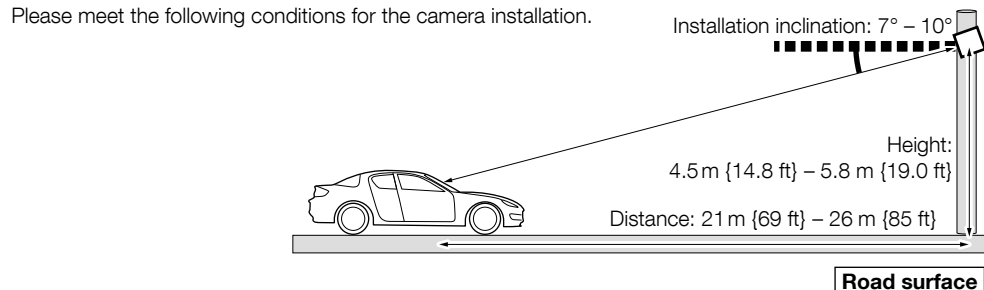

[2] Installation method

- A part of the cable cover is omitted in the following illustrations.

There are 3 methods to install the camera as follows.

Select an installation method in accordance with the conditions of the installation location.

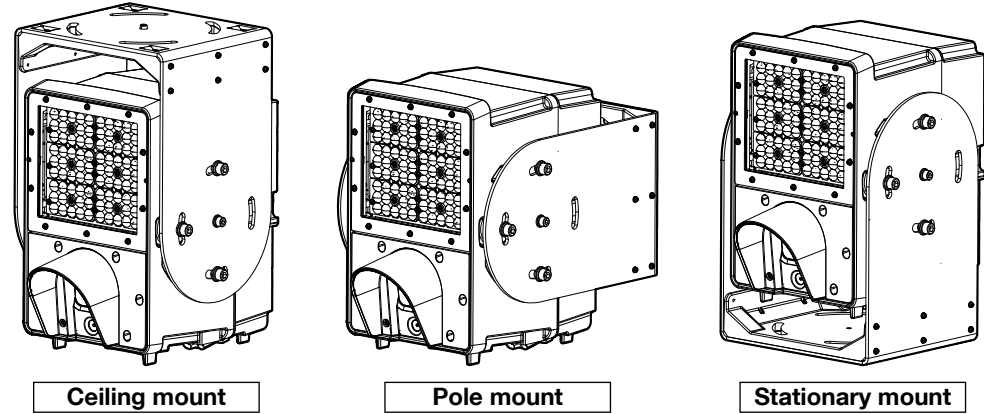

[3] Preparations

- Remove the hexagon screws (M10) (2 pcs.), slide the TILT bracket backwards and then remove it.

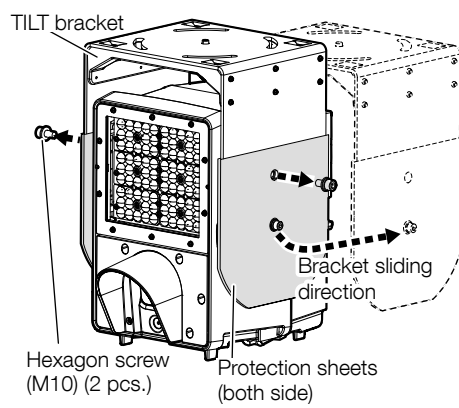

- Note:**
- The removed screws are used with the supplied screws in step [5]. Make sure to keep them.

- Turn the product on its side and remove the protective covers from the cable and other parts on the bottom side.

- Remove the protection sheets (both sides) from the TILT bracket.

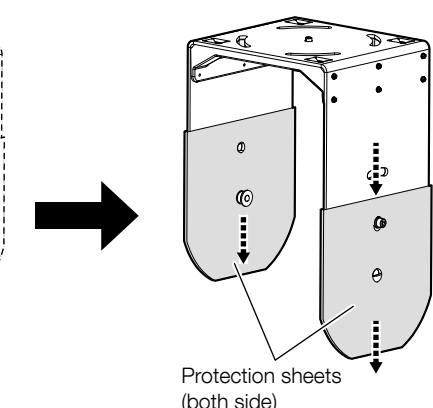

[3] Preparations (Continued)

- Set the "User name" and "Password" for the camera.

Before installing the camera, make sure to connect to a PC to the camera and set the camera's "User name" and "Password" in advance. If necessary, also set the IP address.

- Connect a PC to the camera and connect power to the camera.

- Download the IP Setting Software on your PC and connect to the network by following information described on our support website <Control No.: 0123>.

- The "User name" and "Password" set when first connecting to the camera are used in step [8] when connecting to the camera with a tablet or other device. Make sure to manage them and report them to the administrator.

* On the PC screen, 2 screens for the vicinities around the driver's seat and number plate are displayed.

[4] Work on the installation surface

- Preparing the installation surface

The installation surface for the TILT bracket of the camera is shown on the illustration to the right. Open 4 holes for securing M10 screws at 142 mm {5-19/32 inches} × 142 mm {5-19/32 inches} positions, and open a ø11 mm {7/16 inches} hole so that the PAN rotation is centered. Also, check if there are any uneven areas on the installation surface and if there are any obstructions in the rotating range of the TILT bracket.

- IMPORTANT:**
- <Ceiling mount> <Stationary mount>
 - The installation surface is horizontal.
 - <Pole mount>
 - The installation surface is vertical.

Ceiling mount TOP view

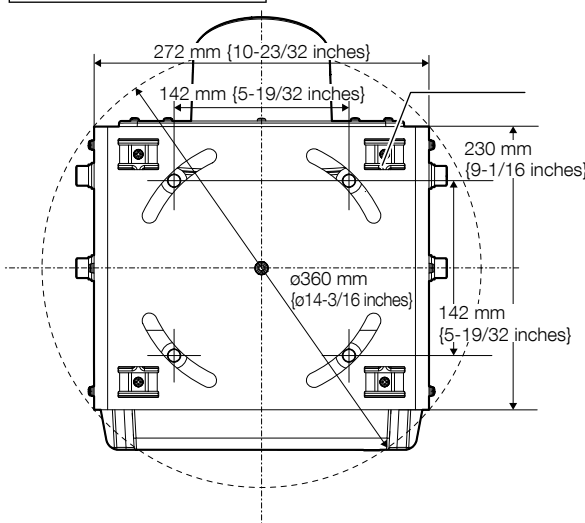

In this Installation Guide, attaching the product to a ceiling surface is explained.

- Temporarily fix the TILT bracket to the installation surface with M10 Bolts and nuts with washers and spring washers (4 sets, locally procured)
Recommended tightening torque: 10.8 N·m {8.0 lbf·ft}

Note:

- Select attaching screws, bolt nuts, anchors, and other parts according to the installation surface and installation method.

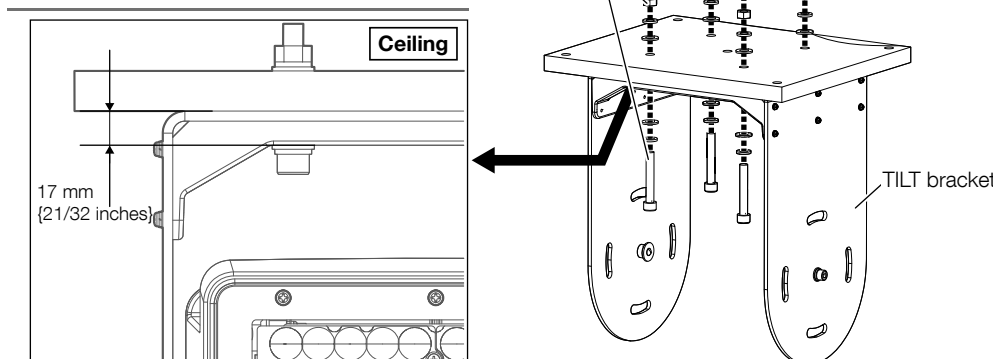

[5] Temporarily attach the camera to the TILT bracket

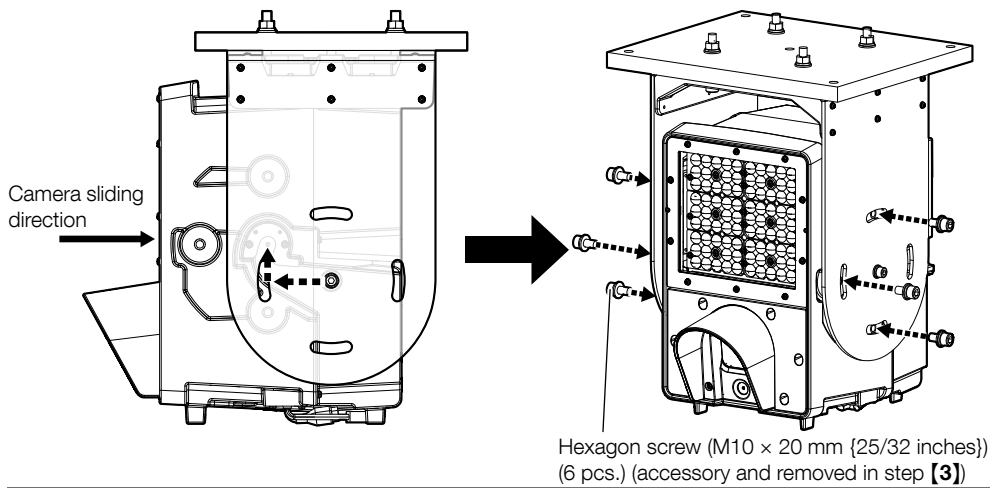

Note:

- As a temporary adjustment, roughly match the PAN and TILT and face the camera in the direction that you want to view images.

[6] Fix the safety wire

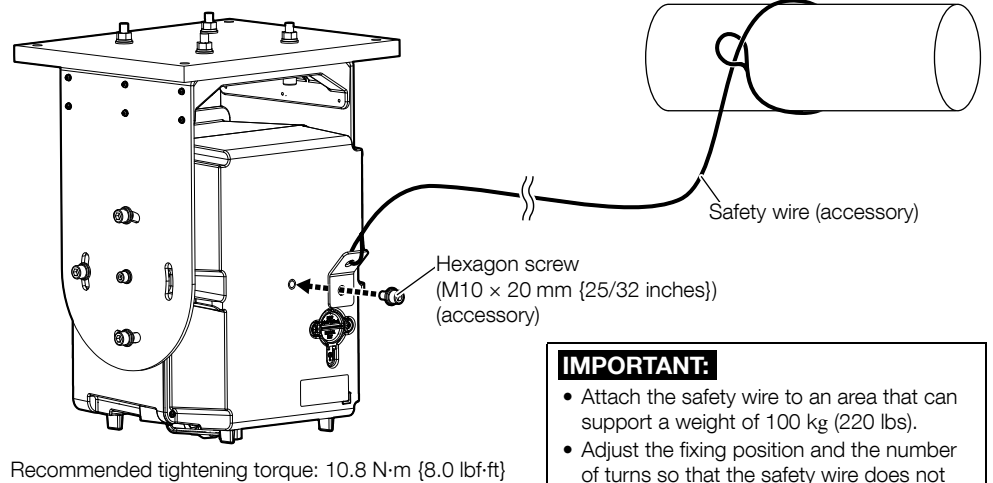

IMPORTANT:

- Attach the safety wire to an area that can support a weight of 100 kg (220 lbs).
- Adjust the fixing position and the number of turns so that the safety wire does not sag.

[7] Connecting wires

IMPORTANT:

- Device to which power can be supplied to this product is a power source with 24 V AC output and less than 250 VA apparent power (capacitance).
- Turn off each system's power supply before making a connection.

- Connect an Ethernet cable (category 5e or better, straight) to RJ45 network cable.

- RJ45 plug (locally procured)
Use an industrial tool (locally procured) to crimp the Ethernet cable (locally procured).
- RJ45 waterproof connector cover (accessory)
- RJ45 waterproof connector cap (accessory)
- Ethernet cable (locally procured)

IMPORTANT:

- Do not install the camera where the RJ45 waterproof connector is exposed to constant rain or moisture.
- When removing the RJ45 waterproof connector, be sure to disconnect it in the reverse order of the procedure on the right figure.

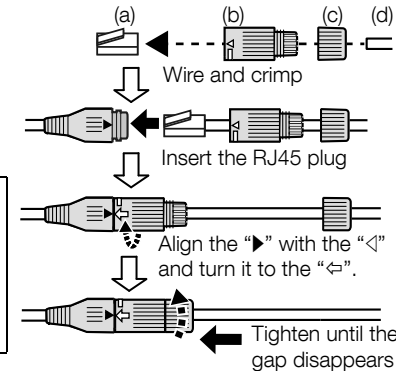

- Assemble 24 V AC connector kit (accessory) and connect it to the power cable of camera body.

- Recommended wire rod and array of pins of connector housing (accessory)

AWG size (stranded wire)	#22 (0.33 mm ²)	#20 (0.52 mm ²)	#18 (0.83 mm ²)
Wire length	7 m {23.0 ft}	14 m {45.9 ft}	20 m {65.6 ft}
Power supply connector housing			
Pin No.	Signal		
1	24 V AC LIVE (Brown)		
2	24 V AC NEUTRAL (Blue)		
3	Ground (Black)		
4	Not use		

- How to assemble the 24 V AC power supply connector kit

- Remove approx. 3 mm {1/8 inches} of the outer jacket of the cable and twist the cable core to prevent the short circuit first.
- Insert the tip of the cable into the point A of the contact (accessory), and hold the cable using the cable clamp.
- Procure either of the following tools for clamping.
Molex manual clamp tool: 57027-5000 (For UL1015), 57026-5000 (For UL1007)
- After clamping the contact and the cable, insert the contact properly into the power supply connector housing.

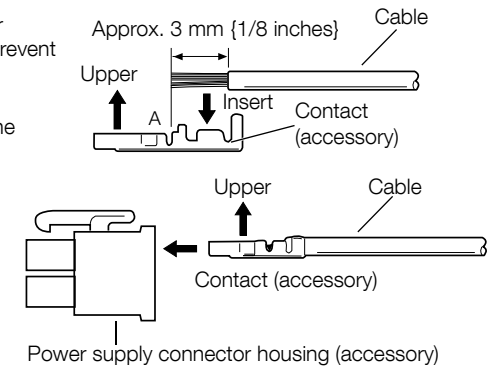

- Adequate waterproof treatment is required for the 24 V AC power cable when installing the camera with cables exposed.

- Apply some waterproof tapes (accessory) as shown in the right.
- Stretch the tape to approx. twice its length and wind it around the cable. Insufficient stretching the tape may cause inadequate waterproofing.

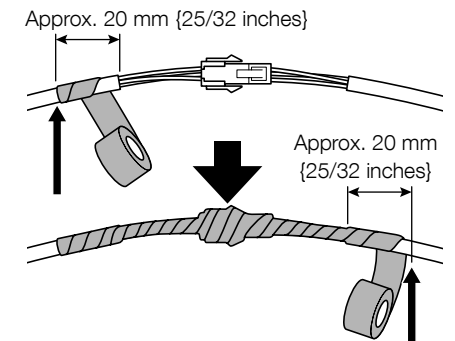

[8] Attach the cable cover to the camera

Note:

- In case of stationary mount, it is no need to attach this cable cover.

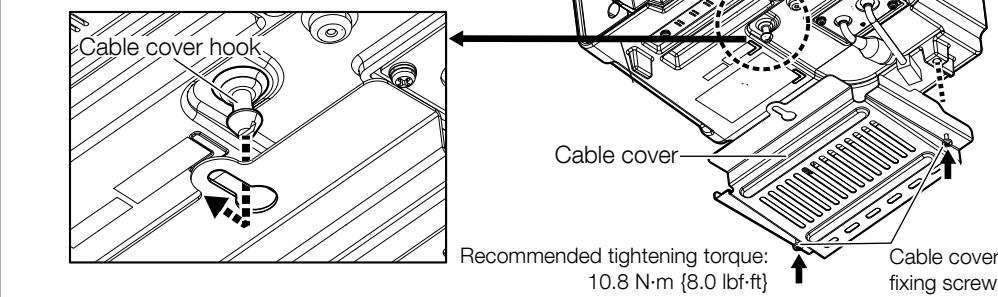

[9] Preparation for adjustment

- Loosen two locking screws of USB cover using the bit (accessory) and pull the USB cover toward you.
- Insert the Wi-Fi USB adapter (locally procured) to the USB terminal (for installation constructor) and then turn on the power of the camera. (The Wi-Fi USB adapter is used only at the time of the installation/servicing.)

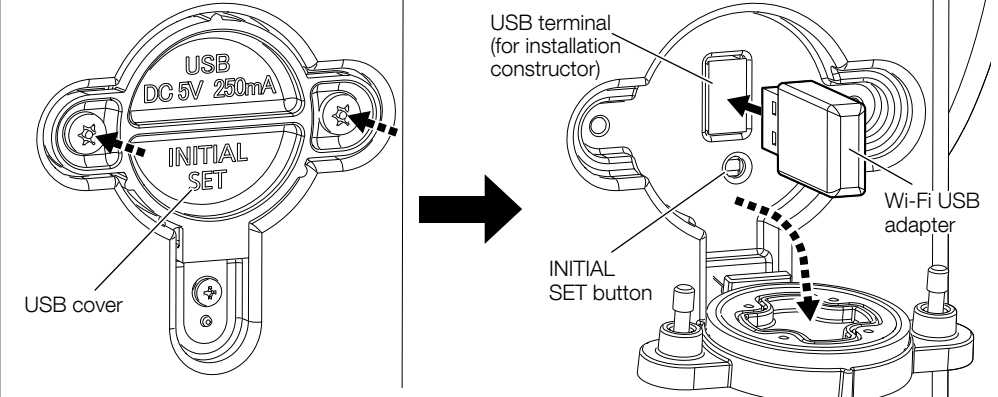

- Select "Wi-Fi" from the setting of a tablet or smart phone and then connect with the Wi-Fi USB adapter (to be locally procured) attached to the camera.

Refer to the manual of the Wi-Fi USB adapter and device in use for how to connect them.
SSID : "Product No._Serial No. of the camera"
Password : "cam_" + "Serial No. of the camera"

- Launch the browser on a tablet or smart phone and then enter the following URL to connect with the camera main unit.
<http://192.168.12.10>



Note:

If access to <http://192.168.12.10> fails, try <http://10.0.0.10>.

- An authentication window is displayed on the screen.
Enter the "User name" and "Password" set in step [3].

- Remove the protection film in regards to the front panel of the camera.

[9] Adjustment

As an example, the explanation is provided using a Wi-Fi USB adapter. When adjusting using a directly connected PC. Refer to "Easy Installation" of the operating instructions on the manual website.

- Step1** Enter the relation between the subject and the camera position.

- Before entering the installation information, measure the distance between the camera and the target object.

- Height:** height from the road surface (4.5 m {14.8 ft} to 5.8 m {19.0 ft})
- Distance:** distance from the subject (21 m {69 ft} to 26 m {85 ft})
- Deflection Distance:** distance from traffic lane of the road (R 7.0 m {23.0 ft} ~ 0 m ~ L 7.0 m {23.0 ft})

- Tap [Next] at the bottom of the screen.

- Step2** When [Next] is tapped, the ideal zoom, focus, and inclination filter restrictions for the camera are adjusted and the live setting screen is displayed.

Note:

If the live screen is not displayed, reload the browser.

- Adjust the direction of the camera to match the camera rotated in the PAN and TILT directions. (If it is difficult to adjust, press [-] of [Zoom], and then press [Reset] after adjusting the PAN and TILT.)

- Use [+] and [-] of [Zoom] to adjust the angle of view. (Adjust so that the driver's seat is in the center of the screen.)

- If necessary, use [F] and [A] of [Focus] to adjust the focus.

- Tighten the M10 Bolts and nuts (4 pcs.) and fix the PAN direction.
Recommended tightening torque: 10.8 N·m {8.0 lbf·ft}

- Tighten the hexagon screws (M10 × 20 mm {25/32 inches}) (6 pcs.) and fix the TILT direction.
Recommended tightening torque: 10.8 N·m {8.0 lbf·ft}

- Once the adjustments are completed, tap [Next] at the bottom of the screen.

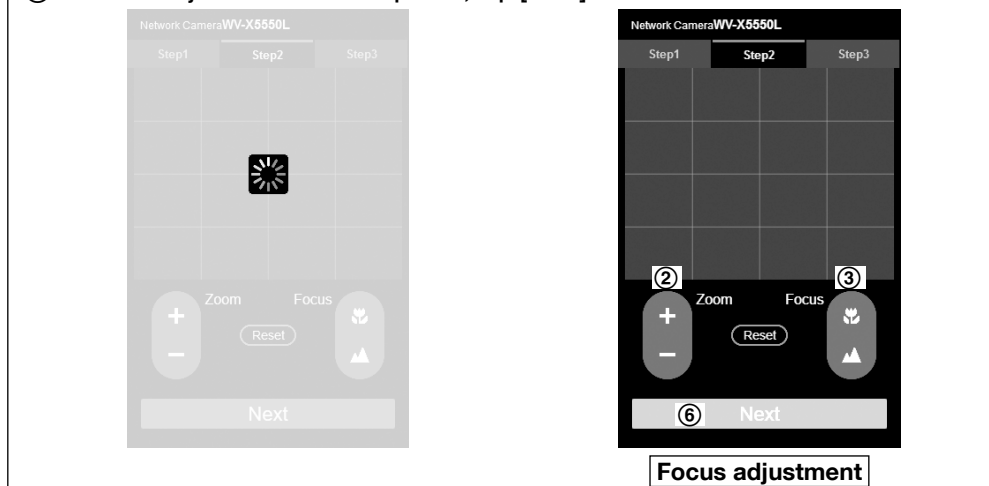

Step3 Finish operations

Note:

For information on detailed adjustment methods, refer to Operating Instructions on the manual website.

- Remove the Wi-Fi USB adapter. (In the case of using a Wi-Fi USB adapter)

- Attach the USB cover and fix it by tighten the USB cover fixing screws (2 places) using the bit (accessory).
Recommended tightening torque: 0.75 N·m {0.55 lbf·ft}

- Connect the camera to a network by following "Configure the network settings" on our support website <Control No.: C0123>

- Close the browser.

Note:

- Check if the focus, brightness, etc. needs to be adjusted on the PC screen before starting operations.

